

**RENOVATIONS AND ADDITION
TO CLASSROOM BUILDINGS
FOLSOM JR. HIGH SCHOOL
ST. TAMMANY PARISH SCHOOL BOARD**

FOLSOM, LOUISIANA

80055 HAY HOLLOW ROAD

DATE ISSUED: 10 JUNE 2009

REVISED:

REVISED:

REVISED:

REVISED:

DRAWN BY: RAB

CHECKED BY: CEV

PHASE:
**CONSTRUCTION
DOCUMENTS**

08060

TITLE:
**LIFE SAFETY
PLAN**

SHEET:

A0.05

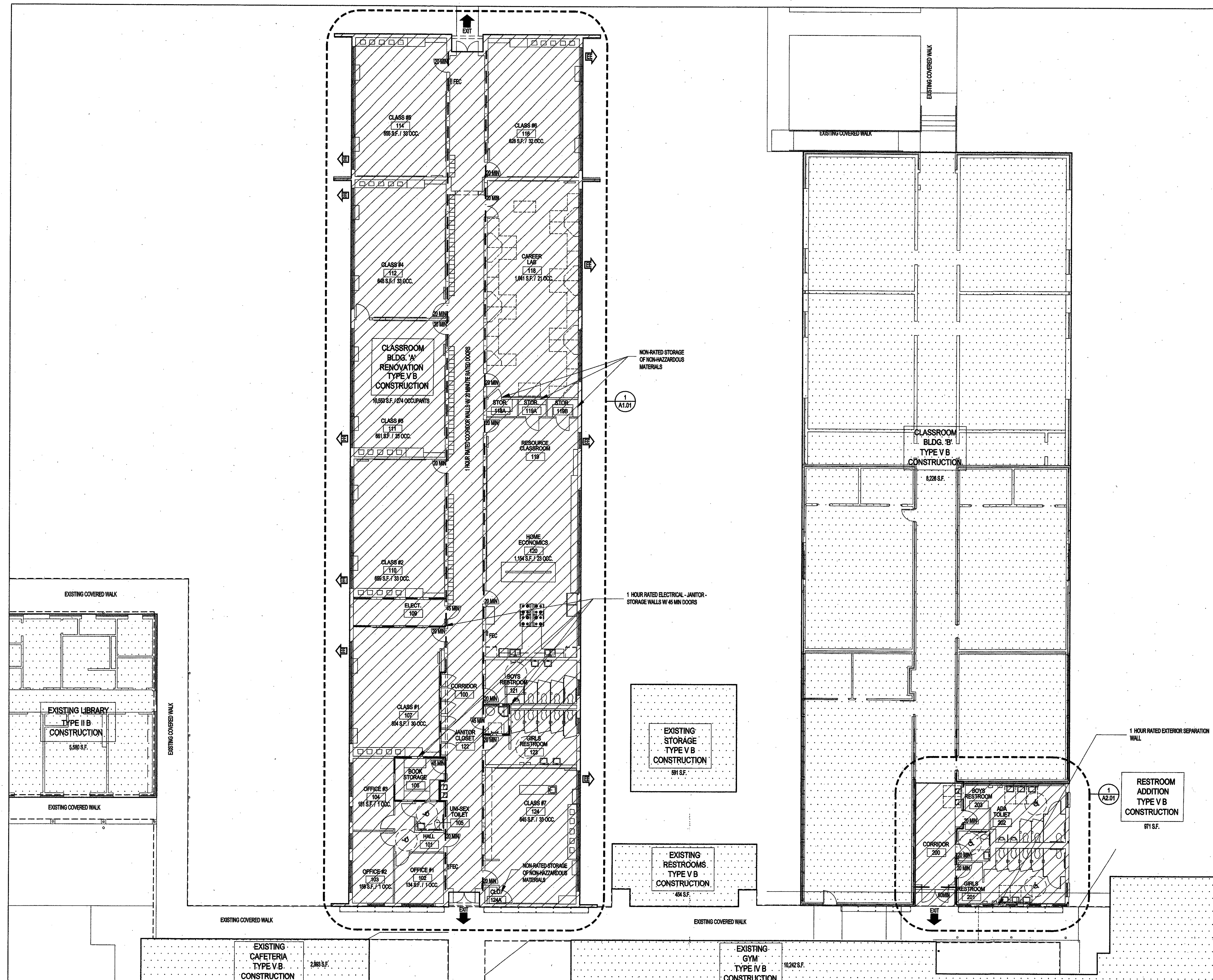

LEGEND:

- NOT IN SCOPE
- RENOVATIONS & ADDITIONS
- EMERGENCY EGRESS WINDOW
- SEMI-RECESSED FIRE EXTINGUISHER CABINET W/ FIRE EXTINGUISHER
- 1-HOUR FIRE RATED WALL
- 2-HOUR FIRE RATED WALL

1 LIFE SAFETY PLAN
A0.05 3/32" = 1'-0"