

**GENERAL NOTES**

- FOR DETAILED ROOM INFORMATION AND CABINET DETAILS REFER TO A-4.0 SHEETS.
- PROVIDE THREE DAY NOTICE PRIOR TO BEGINNING PILE DRIVING.
- ALL FIXTURES TO BE PROVIDED BY OWNER UNLESS OTHERWISE STATED IN THESE DOCUMENTS.

**SPECIFIC NOTES**

- EYE WASH STATION SEE MECHANICAL
- DRINKING FOUNTAIN SEE ELEVATION E-1/A.4.4
- FIRE EXTINGUISHER
- PROVIDE LAB TABLES AS PER SPECIFICATION
- PROVIDE FUME HOOD AS PER SPECIFICATION
- ALLOW ROOM FOR 6" FLANGE WITHIN MECHANICAL CHASE
- SAW CUT CONCRETE SCORE LINES

**AREA CALCULATIONS**

FIRST FLOOR	18,641 SQ. FT.
SECOND FLOOR	18,508 SQ. FT.
MEZZANINE AREA	3,821 SQ. FT.
<b>TOTAL AREA</b>	<b>40,970 SQ. FT.</b>

**LEGEND**

- 8" CMU WALL
- BRICK VENEER WALL

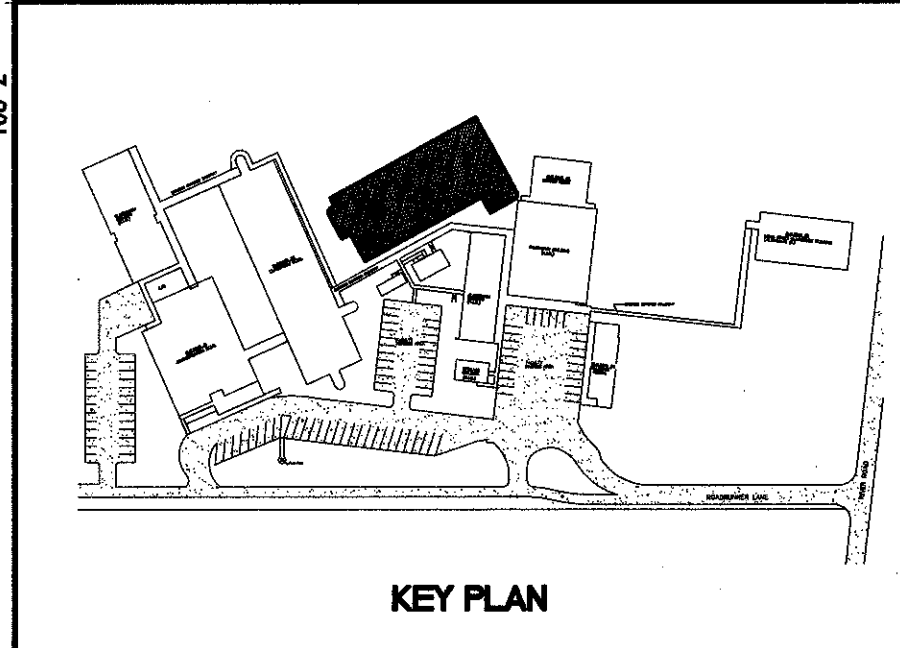

**MURRAY ARCHITECTS**  
 133 Armond Center Court  
 Destrehan, LA 70047  
 (504) 885-7251 / 0282

no.	revisions	date
1		
2		
3		
4		
5		
6		

**HARRY HURST MIDDLE SCHOOL WING ADDITION**  
 170 Roadrunner Lane, Destrehan, Louisiana 70047

SECOND FLOOR PLAN

project number	1007	drawing number <b>A.1.1</b>
date	6.14.2010	
phase	CD	

COPYRIGHT © 2010 BY MURRAY ARCHITECTS. ALL RIGHTS RESERVED. THIS DOCUMENT IS THE PROPERTY OF MURRAY ARCHITECTS AND IS NOT TO BE REPRODUCED OR TRANSMITTED IN ANY FORM OR BY ANY MEANS, ELECTRONIC OR MECHANICAL, INCLUDING PHOTOCOPYING, RECORDING, OR BY ANY INFORMATION STORAGE AND RETRIEVAL SYSTEM. WITHOUT THE WRITTEN PERMISSION OF MURRAY ARCHITECTS, NO PART OF THIS DOCUMENT MAY BE REPRODUCED OR TRANSMITTED IN ANY FORM OR BY ANY MEANS, ELECTRONIC OR MECHANICAL, INCLUDING PHOTOCOPYING, RECORDING, OR BY ANY INFORMATION STORAGE AND RETRIEVAL SYSTEM.

**A-1 SECOND FLOOR PLAN**  
 1/8"=1'-0"