

# DOOR SCHEDULE

MARK	SIZE	FROM	TO	DESCRIPTION	FRAMING	THRESHOLD	HEAD	JAMB	SILL	HARDWARE SET	REMARKS	MARK
1	3'-0" x 7'-0" x 1-3/8"	CORRIDOR 132	EXTERIOR	STOREFRONT	ALUMINUM	ALUMINUM	J-9/A.7.2	E-9/A.7.2	A-9/A.7.2	SEE SPECIFICATIONS 1	45 MIN. FIRE RATED	1
2	3'-0" x 7'-0" x 1-3/8"	STAIR 133	CORRIDOR 132	SOLID CORE WOOD DOOR	HOLLOW METAL		J-13/A.7.1	E-13/A.7.1	A-13/A.7.1	SEE SPECIFICATIONS 2	1 HR. FIRE RATED	2
3	3'-0" x 7'-0" x 1-3/8"	CORRIDOR 132	EXTERIOR	STOREFRONT	ALUMINUM	ALUMINUM	J-5/A.7.1	E-5/A.7.1	A-5/A.7.1	SEE SPECIFICATIONS 1	45 MIN. FIRE RATED	3
4	3'-0" x 7'-0" x 1-3/8"	CORRIDOR 132	CLASSROOM 100	SOLID CORE WOOD DOOR	HOLLOW METAL		J-13/A.7.1	E-13/A.7.1	A-13/A.7.1	SEE SPECIFICATIONS 3	8x36" LITES IN ALL CLASSROOM DOORS	4
5	3'-0" x 7'-0" x 1-3/8"	CORRIDOR 132	CLASSROOM 131	SOLID CORE WOOD DOOR	HOLLOW METAL		J-13/A.7.1	E-13/A.7.1	A-13/A.7.1	SEE SPECIFICATIONS 3	8x36" LITES IN ALL CLASSROOM DOORS	5
6	3'-0" x 7'-0" x 1-3/8"	CORRIDOR 132	CLASSROOM 101	SOLID CORE WOOD DOOR	HOLLOW METAL		J-13/A.7.1	E-13/A.7.1	A-13/A.7.1	SEE SPECIFICATIONS 3	8x36" LITES IN ALL CLASSROOM DOORS	6
7	3'-0" x 7'-0" x 1-3/8"	CORRIDOR 132	CLASSROOM 130	SOLID CORE WOOD DOOR	HOLLOW METAL		J-13/A.7.1	E-13/A.7.1	A-13/A.7.1	SEE SPECIFICATIONS 3	8x36" LITES IN ALL CLASSROOM DOORS	7
8	3'-0" x 7'-0" x 1-3/8"	CORRIDOR 132	CLASSROOM 102	SOLID CORE WOOD DOOR	HOLLOW METAL		J-13/A.7.1	E-13/A.7.1	A-13/A.7.1	SEE SPECIFICATIONS 3	8x36" LITES IN ALL CLASSROOM DOORS	8
9	3'-0" x 7'-0" x 1-3/8"	CORRIDOR 132	CLASSROOM 129	SOLID CORE WOOD DOOR	HOLLOW METAL		J-13/A.7.1	E-13/A.7.1	A-13/A.7.1	SEE SPECIFICATIONS 3	8x36" LITES IN ALL CLASSROOM DOORS	9
10	3'-0" x 7'-0" x 1-3/8"	CORRIDOR 132	SCIENCE LAB 103	SOLID CORE WOOD DOOR	HOLLOW METAL		J-13/A.7.1	E-13/A.7.1	A-13/A.7.1	SEE SPECIFICATIONS 3	8x36" LITES IN ALL CLASSROOM DOORS	10
11	3'-0" x 7'-0" x 1-3/8"	CORRIDOR 132	CLASSROOM 128	SOLID CORE WOOD DOOR	HOLLOW METAL		J-13/A.7.1	E-13/A.7.1	A-13/A.7.1	SEE SPECIFICATIONS 3	8x36" LITES IN ALL CLASSROOM DOORS	11
12	3'-0" x 7'-0" x 1-3/8"	CORRIDOR 132	SCIENCE LAB 103	SOLID CORE WOOD DOOR	HOLLOW METAL		J-13/A.7.1	E-13/A.7.1	A-13/A.7.1	SEE SPECIFICATIONS 3	8x36" LITES IN ALL CLASSROOM DOORS	12
13	3'-0" x 7'-0" x 1-3/8"	CORRIDOR 132	CLASSROOM 127	SOLID CORE WOOD DOOR	HOLLOW METAL		J-13/A.7.1	E-13/A.7.1	A-13/A.7.1	SEE SPECIFICATIONS 3	8x36" LITES IN ALL CLASSROOM DOORS	13
14	3'-0" x 7'-0" x 1-3/8"	CORRIDOR 132	CUSTODIAL 107	SOLID CORE WOOD DOOR	HOLLOW METAL		J-13/A.7.1	E-13/A.7.1	A-13/A.7.1	SEE SPECIFICATIONS 4		14
15	3'-0" x 7'-0" x 1-3/8"	CORRIDOR 132	STORAGE 125	SOLID CORE WOOD DOOR	HOLLOW METAL		J-13/A.7.1	E-13/A.7.1	A-13/A.7.1	SEE SPECIFICATIONS 3		15
16	3'-0" x 7'-0" x 1-3/8"	CORRIDOR 124	STORAGE 108	SOLID CORE WOOD DOOR	HOLLOW METAL		J-13/A.7.1	E-13/A.7.1	A-13/A.7.1	SEE SPECIFICATIONS 3		16
17	3'-0" x 7'-0" x 1-3/8"	CORRIDOR 124	CLASSROOM 109	SOLID CORE WOOD DOOR	HOLLOW METAL		J-13/A.7.1	E-13/A.7.1	A-13/A.7.1	SEE SPECIFICATIONS 3	8x36" LITES IN ALL CLASSROOM DOORS, 1 HR. FIRE RATED	17
18	3'-0" x 7'-0" x 1-3/8"	CORRIDOR 124	STAIR 3 112	SOLID CORE WOOD DOOR	HOLLOW METAL		J-13/A.7.1	E-13/A.7.1	A-13/A.7.1	SEE SPECIFICATIONS 2	1 HR. FIRE RATED	18
19	3'-0" x 7'-0" x 1-3/8"	CORRIDOR 124	COMPUTER LAB 113	SOLID CORE WOOD DOOR	HOLLOW METAL		J-13/A.7.1	E-13/A.7.1	A-13/A.7.1	SEE SPECIFICATIONS 3	8x36" LITES IN ALL CLASSROOM DOORS	19
20	3'-0" x 7'-0" x 1-3/8"	IT 114	CORRIDOR 124	SOLID CORE WOOD DOOR	HOLLOW METAL		J-13/A.7.1	E-13/A.7.1	A-13/A.7.1	SEE SPECIFICATIONS 3		20
21	3'-0" x 7'-0" x 1-3/8"	STAIR 115	CORRIDOR 124	SOLID CORE WOOD DOOR	HOLLOW METAL		J-13/A.7.1	E-13/A.7.1	A-13/A.7.1	SEE SPECIFICATIONS 2	1 HR. FIRE RATED	21
22	3'-0" x 7'-0" x 1-3/8"	CORRIDOR 124	EXTERIOR	STOREFRONT	ALUMINUM	ALUMINUM	J-9/A.7.2	E-9/A.7.2	A-9/A.7.2	SEE SPECIFICATIONS 1		22
23	3'-0" x 7'-0" x 1-3/8"	IT 114	COMPUTER LAB	SOLID CORE WOOD DOOR	HOLLOW METAL		J-13/A.7.1	E-13/A.7.1	A-13/A.7.1	SEE SPECIFICATIONS 3		23
24	3'-0" x 7'-0" x 1-3/8"	ELECTRICAL 134	EXTERIOR	GALV. METAL DOOR	GALVANIZED HOLLOW METAL	ALUMINUM	J-13/A.7.2	E-13/A.7.2	A-13/A.7.2	SEE SPECIFICATIONS 4		24
25	3'-0" x 7'-0" x 1-3/8"	COMPUTER LAB 113	EXTERIOR	STOREFRONT	ALUMINUM	ALUMINUM	J-5/A.7.1	E-5/A.7.1	A-5/A.7.1	SEE SPECIFICATIONS 1		25
26	3'-0" x 7'-0" x 1-3/8"	STAIR 3 112	EXTERIOR	STOREFRONT	ALUMINUM	ALUMINUM	J-5/A.7.1	E-5/A.7.1	A-5/A.7.1	SEE SPECIFICATIONS 1		26
27	PR. 3'-0" x 7'-0" x 1-3/8"	BOILER ROOM 135	EXTERIOR	GALV. METAL DOOR	GALVANIZED HOLLOW METAL	ALUMINUM	J-13/A.7.2	E-13/A.7.2	A-13/A.7.2	SEE SPECIFICATIONS 4	DOUBLE DOOR	27
28	3'-0" x 7'-0" x 1-3/8"	CLASSROOM 109	EXTERIOR	STOREFRONT	ALUMINUM	ALUMINUM	J-5/A.7.1	E-5/A.7.1	A-5/A.7.1	SEE SPECIFICATIONS 1		28
29	3'-0" x 7'-0" x 1-3/8"	CLASSROOM 109	CHANGE ROOM 110	SOLID CORE WOOD DOOR	HOLLOW METAL		J-13/A.7.1	E-13/A.7.1	A-13/A.7.1	SEE SPECIFICATIONS 6		29
30	3'-0" x 7'-0" x 1-3/8"	CHANGE ROOM 110	TOILET ROOM 111	SOLID CORE WOOD DOOR	HOLLOW METAL		J-13/A.7.1	E-13/A.7.1	A-13/A.7.1	SEE SPECIFICATIONS 6		30
31	3'-0" x 7'-0" x 1-3/8"	SCIENCE LAB 103	EXTERIOR	STOREFRONT	ALUMINUM	ALUMINUM	J-5/A.7.1	E-5/A.7.1	A-5/A.7.1	SEE SPECIFICATIONS 1		31
32	3'-0" x 7'-0" x 1-3/8"	SCIENCE LAB 103	CLASSROOM 102	SOLID CORE WOOD DOOR	HOLLOW METAL		J-13/A.7.1	E-13/A.7.1	A-13/A.7.1	SEE SPECIFICATIONS 5		32
33	3'-0" x 7'-0" x 1-3/8"	CLASSROOM 101	CLASSROOM 100	SOLID CORE WOOD DOOR	HOLLOW METAL		J-13/A.7.1	E-13/A.7.1	A-13/A.7.1	SEE SPECIFICATIONS 5		33
34	3'-0" x 7'-0" x 1-3/8"	CLASSROOM 130	CLASSROOM 131	SOLID CORE WOOD DOOR	HOLLOW METAL		J-13/A.7.1	E-13/A.7.1	A-13/A.7.1	SEE SPECIFICATIONS 5		34
35	3'-0" x 7'-0" x 1-3/8"	CLASSROOM 128	CLASSROOM 129	SOLID CORE WOOD DOOR	HOLLOW METAL		J-13/A.7.1	E-13/A.7.1	A-13/A.7.1	SEE SPECIFICATIONS 5		35
36	3'-0" x 7'-0" x 1-3/8"	HALL 116	MEN 120	SOLID CORE WOOD DOOR	HOLLOW METAL		J-13/A.7.1	E-13/A.7.1	A-13/A.7.1	SEE SPECIFICATIONS 6		36
37	3'-0" x 7'-0" x 1-3/8"	HALL 116	ADMINISTRATION 119	SOLID CORE WOOD DOOR	HOLLOW METAL		J-13/A.7.1	E-13/A.7.1	A-13/A.7.1	SEE SPECIFICATIONS 7		37
38	3'-0" x 7'-0" x 1-3/8"	HALL 116	WOMEN 121	SOLID CORE WOOD DOOR	HOLLOW METAL		J-13/A.7.1	E-13/A.7.1	A-13/A.7.1	SEE SPECIFICATIONS 6		38
39	3'-0" x 7'-0" x 1-3/8"	HALL 116	ADMINISTRATION 118	SOLID CORE WOOD DOOR	HOLLOW METAL		J-13/A.7.1	E-13/A.7.1	A-13/A.7.1	SEE SPECIFICATIONS 7		39
40	3'-0" x 7'-0" x 1-3/8"	HALL 116	CLOSET 122	SOLID CORE WOOD DOOR	HOLLOW METAL		J-13/A.7.1	E-13/A.7.1	A-13/A.7.1	SEE SPECIFICATIONS 7		40
41	3'-0" x 7'-0" x 1-3/8"	HALL 116	ADMINISTRATION 123	SOLID CORE WOOD DOOR	HOLLOW METAL		J-13/A.7.1	E-13/A.7.1	A-13/A.7.1	SEE SPECIFICATIONS 7		41
42	3'-0" x 7'-0" x 1-3/8"	CORRIDOR 124	HALL 116	HOLLOW METAL	HOLLOW METAL		J-13/A.7.1	E-13/A.7.1	A-13/A.7.1	SEE SPECIFICATIONS 7	8x36" LITES IN ALL CLASSROOM DOORS	42
43	3'-0" x 7'-0" x 1-3/8"	HALL 116	ADMINISTRATION 117	SOLID CORE WOOD DOOR	HOLLOW METAL		J-13/A.7.1	E-13/A.7.1	A-13/A.7.1	SEE SPECIFICATIONS 7		43
44	3'-0" x 7'-0" x 1-3/8"	CORRIDOR 223	STAIR 133	SOLID CORE WOOD DOOR	HOLLOW METAL		J-13/A.7.1	E-13/A.7.1	A-13/A.7.1	SEE SPECIFICATIONS 4	1 HR. FIRE RATED	44
45	3'-0" x 7'-0" x 1-3/8"	CORRIDOR 223	CLASSROOM 200	SOLID CORE WOOD DOOR	HOLLOW METAL		J-13/A.7.1	E-13/A.7.1	A-13/A.7.1	SEE SPECIFICATIONS 3	8x36" LITES IN ALL CLASSROOM DOORS	45
46	3'-0" x 7'-0" x 1-3/8"	CORRIDOR 223	CLASSROOM 222	SOLID CORE WOOD DOOR	HOLLOW METAL		J-13/A.7.1	E-13/A.7.1	A-13/A.7.1	SEE SPECIFICATIONS 3	8x36" LITES IN ALL CLASSROOM DOORS	46
47	3'-0" x 7'-0" x 1-3/8"	CORRIDOR 223	CLASSROOM 201	SOLID CORE WOOD DOOR	HOLLOW METAL		J-13/A.7.1	E-13/A.7.1	A-13/A.7.1	SEE SPECIFICATIONS 3	8x36" LITES IN ALL CLASSROOM DOORS	47
48	3'-0" x 7'-0" x 1-3/8"	CORRIDOR 223	CLASSROOM 221	SOLID CORE WOOD DOOR	HOLLOW METAL		J-13/A.7.1	E-13/A.7.1	A-13/A.7.1	SEE SPECIFICATIONS 3	8x36" LITES IN ALL CLASSROOM DOORS	48
49	3'-0" x 7'-0" x 1-3/8"	CORRIDOR 223	CLASSROOM 202	SOLID CORE WOOD DOOR	HOLLOW METAL		J-13/A.7.1	E-13/A.7.1	A-13/A.7.1	SEE SPECIFICATIONS 3	8x36" LITES IN ALL CLASSROOM DOORS	49
50	3'-0" x 7'-0" x 1-3/8"	CORRIDOR 223	CLASSROOM 220	SOLID CORE WOOD DOOR	HOLLOW METAL		J-13/A.7.1	E-13/A.7.1	A-13/A.7.1	SEE SPECIFICATIONS 3	8x36" LITES IN ALL CLASSROOM DOORS	50
51	3'-0" x 7'-0" x 1-3/8"	CORRIDOR 223	CLASSROOM 203	SOLID CORE WOOD DOOR	HOLLOW METAL		J-13/A.7.1	E-13/A.7.1	A-13/A.7.1	SEE SPECIFICATIONS 3	8x36" LITES IN ALL CLASSROOM DOORS	51
52	3'-0" x 7'-0" x 1-3/8"	CORRIDOR 223	CLASSROOM 219	SOLID CORE WOOD DOOR	HOLLOW METAL		J-13/A.7.1	E-13/A.7.1	A-13/A.7.1	SEE SPECIFICATIONS 3	8x36" LITES IN ALL CLASSROOM DOORS	52
53	3'-0" x 7'-0" x 1-3/8"	CORRIDOR 223	CLASSROOM 204	SOLID CORE WOOD DOOR	HOLLOW METAL		J-13/A.7.1	E-13/A.7.1	A-13/A.7.1	SEE SPECIFICATIONS 3	8x36" LITES IN ALL CLASSROOM DOORS	53
54	3'-0" x 7'-0" x 1-3/8"	CORRIDOR 223	CLASSROOM 218	SOLID CORE WOOD DOOR	HOLLOW METAL		J-13/A.7.1	E-13/A.7.1	A-13/A.7.1	SEE SPECIFICATIONS 3	8x36" LITES IN ALL CLASSROOM DOORS	54
55	3'-0" x 7'-0" x 1-3/8"	ELEVATOR EQUIPMENT 217	CORRIDOR 223	SOLID CORE WOOD DOOR	HOLLOW METAL		J-13/A.7.1	E-13/A.7.1	A-13/A.7.1	SEE SPECIFICATIONS 4	1 HR. FIRE RATED	55
56	3'-0" x 7'-0" x 1-3/8"	CORRIDOR 223	CUSTODIAL 207	SOLID CORE WOOD DOOR	HOLLOW METAL		J-13/A.7.1	E-13/A.7.1	A-13/A.7.1	SEE SPECIFICATIONS 4		56
57	3'-0" x 7'-0" x 1-3/8"	CORRIDOR 223	ELECTRICAL 216	SOLID CORE WOOD DOOR	HOLLOW METAL		J-13/A.7.1	E-13/A.7.1	A-13/A.7.1	SEE SPECIFICATIONS 4		57
58	3'-0" x 7'-0" x 1-3/8"	CORRIDOR 212	STORAGE 208	SOLID CORE WOOD DOOR	HOLLOW METAL		J-13/A.7.1	E-13/A.7.1	A-13/A.7.1	SEE SPECIFICATIONS 4		58
59	3'-0" x 7'-0" x 1-3/8"	CORRIDOR 212	CLASSROOM 209	SOLID CORE WOOD DOOR	HOLLOW METAL		J-13/A.7.1	E-13/A.7.1	A-13/A.7.1	SEE SPECIFICATIONS 3	8x36" LITES IN ALL CLASSROOM DOORS	59
60	3'-0" x 7'-0" x 1-3/8"	CORRIDOR 212	STAIR 3 112	SOLID CORE WOOD DOOR	HOLLOW METAL		J-13/A.7.1	E-13/A.7.1	A-13/A.7.1	SEE SPECIFICATIONS 2	1 HR. FIRE RATED	60
61	3'-0" x 7'-0" x 1-3/8"	CORRIDOR 212	MEN 215	SOLID CORE WOOD DOOR	HOLLOW METAL		J-13/A.7.1	E-13/A.7.1	A-13/A.7.1	SEE SPECIFICATIONS 6		61
62	3'-0" x 7'-0" x 1-3/8"	CORRIDOR 212	CONFERENCE 210	SOLID CORE WOOD DOOR	HOLLOW METAL		J-13/A.7.1	E-13/A.7.1	A-13/A.7.1	SEE SPECIFICATIONS 3		62
63	3'-0" x 7'-0" x 1-3/8"	CORRIDOR 212	WOMEN 214	SOLID CORE WOOD DOOR	HOLLOW METAL		J-13/A.7.1	E-13/A.7.1	A-13/A.7.1	SEE SPECIFICATIONS 6		63
64	3'-0" x 7'-0" x 1-3/8"	CORRIDOR 212	CLASSROOM 211	SOLID CORE WOOD DOOR	HOLLOW METAL		J-13/A.7.1	E-13/A.7.1	A-13/A.7.1	SEE SPECIFICATIONS 3	8x36" LITES IN ALL CLASSROOM DOORS	64
65	3'-0" x 7'-0" x 1-3/8"	CORRIDOR 212	LOUNGE 213	SOLID CORE WOOD DOOR	HOLLOW METAL		J-13/A.7.1	E-13/A.7.1	A-13/A.7.1	SEE SPECIFICATIONS 3	8x36" LITES IN ALL CLASSROOM DOORS	65
66	3'-0" x 7'-0" x 1-3/8"	CORRIDOR 212	STAIR 115	SOLID CORE WOOD DOOR	HOLLOW METAL		J-13/A.7.1	E-13/A.7.1	A-13/A.7.1	SEE SPECIFICATIONS 4	1 HR. FIRE RATED	66
67	3'-0" x 7'-0" x 1-3/8"	CLASSROOM 218	CLASSROOM 220	SOLID CORE WOOD DOOR	HOLLOW METAL		J-13/A.7.1	E-13/A.7.1	A-13/A.7.1	SEE SPECIFICATIONS 5		67
68	3'-0" x 7'-0" x 1-3/8"	CLASSROOM 221	CLASSROOM 222	SOLID CORE WOOD DOOR	HOLLOW METAL		J-13/A.7.1	E-13/A.7.1	A-13/A.7.1	SEE SPECIFICATIONS 5		68
69	3'-0" x 7'-0" x 1-3/8"	CLASSROOM 201	CLASSROOM 200	SOLID CORE WOOD DOOR	HOLLOW METAL		J-13/A.7.1	E-13/A.7.1	A-13/A.7.1	SEE SPECIFICATIONS 5		69
70	3'-0" x 7'-0" x 1-3/8"	CLASSROOM 203	CLASSROOM 202	SOLID CORE WOOD DOOR	HOLLOW METAL		J-13/A.7.1	E-13/A.7.1	A-13/A.7.1	SEE SPECIFICATIONS 5		70
71	3'-0" x 7'-0" x 1-3/8"	SCIENCE LAB 103	STORAGE 104	SOLID CORE WOOD DOOR	HOLLOW METAL		J-5/A.7.2	E-5/A.7.2	A-5/A.7.2	SEE SPECIFICATIONS 4		71

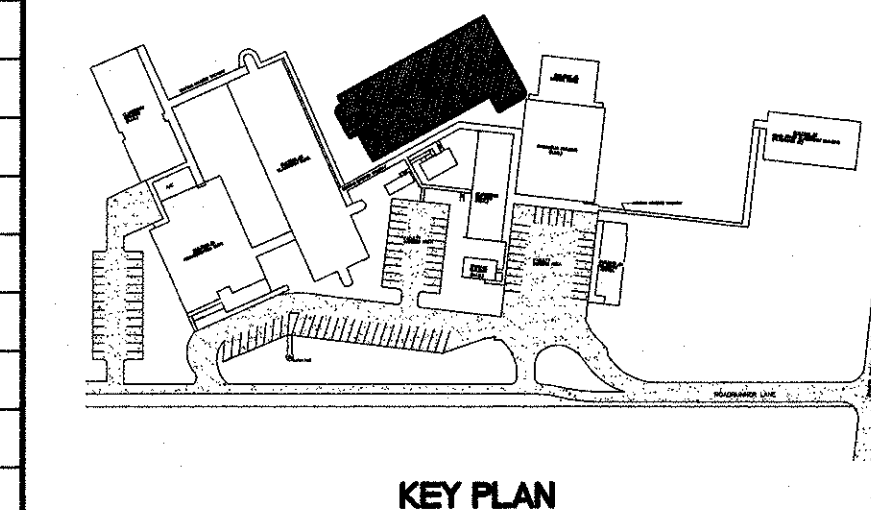

no.	revisions	date
1		
2		
3		
4		
5		
6		

**HARRY HURST MIDDLE SCHOOL  
WING ADDITION**

170 Roadrunner Lane, Destrehan, Louisiana 70047

DOOR SCHEDULE

MICHAEL TABB  
REG. NO. 0499  
STATE OF LOUISIANA

project number  
1007  
date  
6.14.2010  
phase  
CD

A.4.1

THIS DOCUMENT IS THE PROPERTY OF MURRAY ARCHITECTS. IT IS TO BE USED ONLY FOR THE PROJECT AND LOCATION SPECIFICALLY IDENTIFIED HEREIN. IT IS NOT TO BE REPRODUCED, COPIED, OR TRANSMITTED IN ANY FORM OR BY ANY MEANS, ELECTRONIC OR MECHANICAL, INCLUDING PHOTOCOPYING, RECORDING, OR BY ANY INFORMATION STORAGE AND RETRIEVAL SYSTEM, WITHOUT THE WRITTEN PERMISSION OF MURRAY ARCHITECTS.