

SPECIFIC NOTES

- 1 GYPSUM BOARD
- 2 2'x2' ACOUSTICAL CEILING TILE SYSTEM
- 3 ALUMINUM SOFFIT
- 4 EXPOSED CEILING
- 5 SHEET ROCK LAY-IN CEILING

LEGEND

-  SHEET ROCK LAY-IN CEILING
-  2'x2' ACOUSTICAL CEILING TILE SYSTEM
-  GYPSUM BOARD

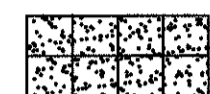
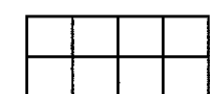
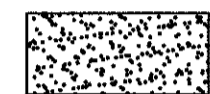
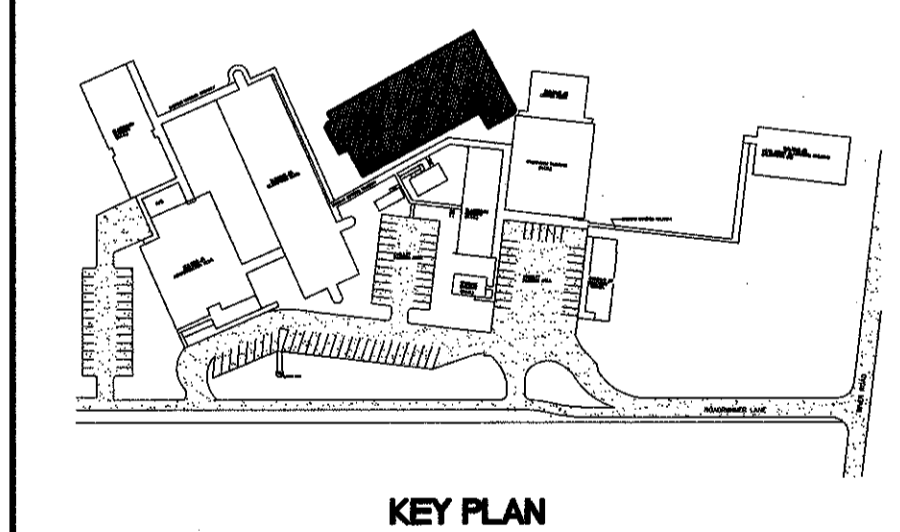

MURRAY ARCHITECTS
 133 Armond Center Court
 Baton Rouge, LA 70801
 (504) 775-7107
 Fax: (504) 775-0182

no.	revisions	date
1		
2		
3		
4		
5		
6		

HARRY HURST MIDDLE SCHOOL WING ADDITION
 170 Roadrunner Lane, Destrehan, Louisiana 70047
 SECOND FLOOR REFLECTED CEILING PLAN

MURRAY ARCHITECTS
 MICHAEL TABB
 REG. NO. 0586
 PROJECT NUMBER: 1007
 DATE: 6.14.2010
 PHASE: CD
 DRAWING NUMBER: **A.6.1**

THESE DOCUMENTS ARE PROTECTED BY UNITED STATES COPYRIGHT LAW. THEY HAVE BEEN PREPARED SPECIFICALLY FOR THE PROJECT, SITE, AND LOCATION AND ARE NOT BE LOANED, REPRODUCED, COPIED, OR IN ANY MANNER REPRODUCED OR TRANSMITTED IN ANY FORM OR BY ANY MEANS, ELECTRONIC OR MECHANICAL, INCLUDING PHOTOCOPYING, RECORDING, OR BY ANY INFORMATION STORAGE AND RETRIEVAL SYSTEM, WITHOUT THE WRITTEN PERMISSION AND SIGNATURE OF THE ARCHITECT. ALL RIGHTS ARE RESERVED TO MURRAY ARCHITECTS.

A-1 SECOND FLOOR REFLECTED CEILING PLAN

3/32"=1'-0"