

**3. DETAIL - ROOF**  
SCALE: 3" = 1'-0"

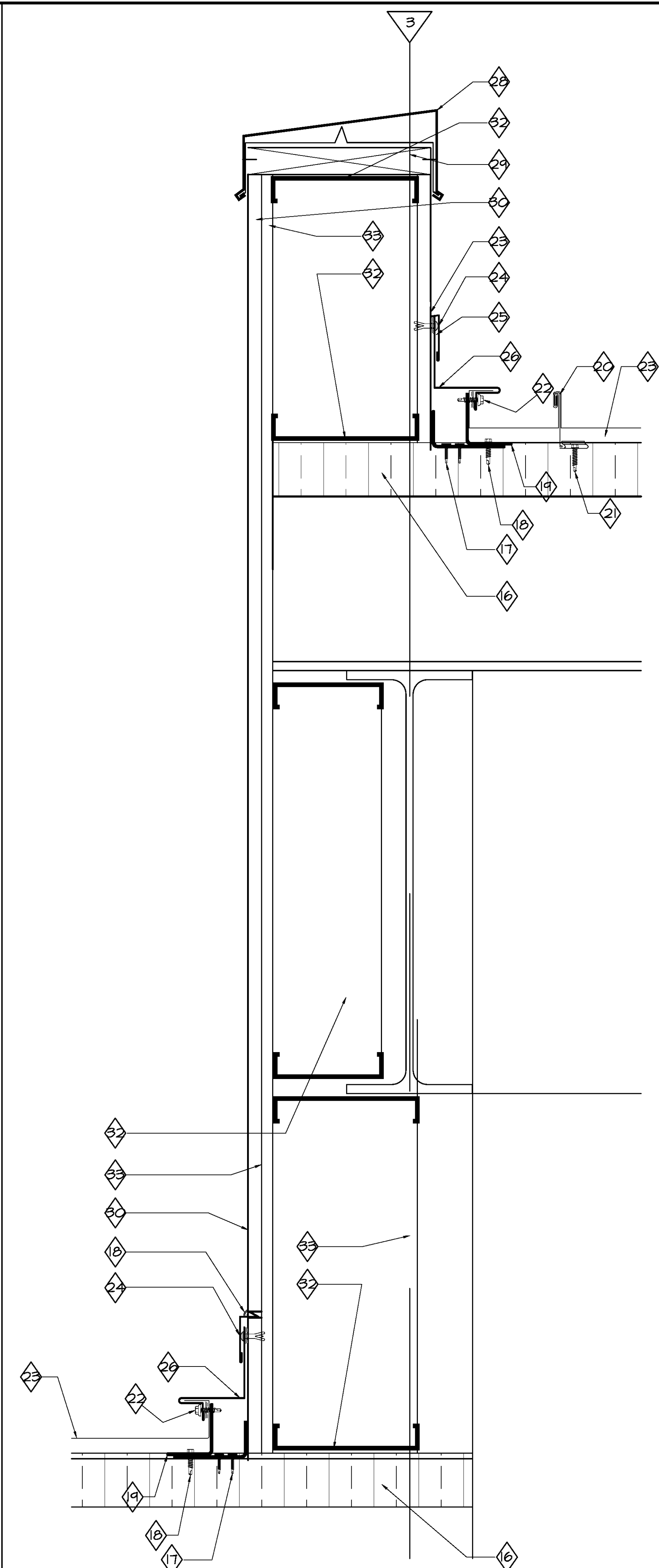

**2. DETAIL - ROOF**  
SCALE: 3" = 1'-0"

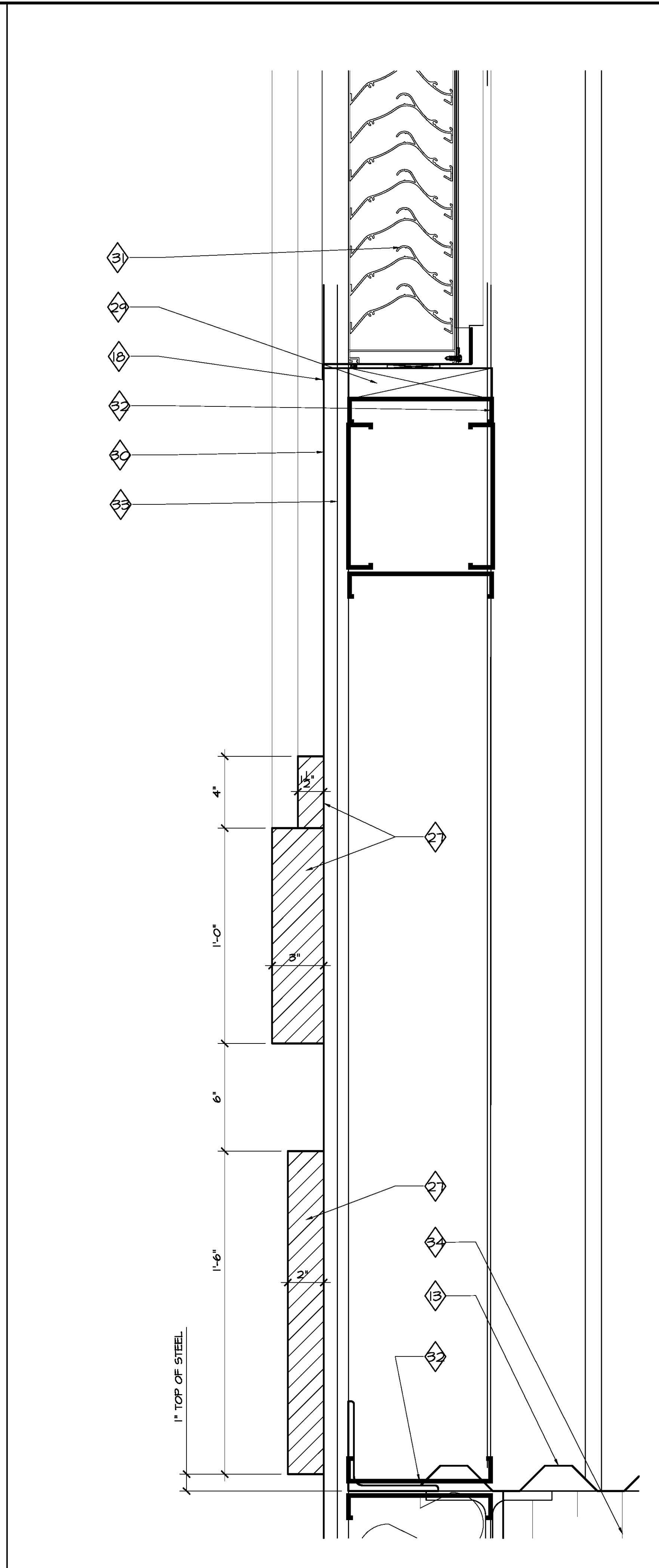

**1. DETAIL - ROOF**  
SCALE: 3" = 1'-0"

- 1 1/4 -14 X 7/8 LONG-LIFE LAPTEK W/WASHER [FASTENER #4 (2 PER STRAP), RE: (07411)]
- 2 1/4-14 X 7/8 LONG-LIFE LAPTEK W/WASHER [FASTENER #4 @12" O.C., RE: (07411).
- 3 EAVE TRIM, RE: (07411)
- 4 GUTTER, RE: (07411)
- 5 GUTTER STRAP @ EVERY OTHER RIB, RE: (07411)
- 6 EAVE STRUT, RE: (07411)
- 7 TRI-BEAD TAPE SEALER, RE: (07411)
- 8 1/4-14 x 1 1/4 SHOULDER TEK 2 SELF-DRILLER [FASTENER #5] @12 O.C. RE: (07411)
- 9 1/8 x 3/16 POP RIVET [FASTENER #14] @ 5'-0" O.C. (07411)
- 10 VENTED RIDGE FLASHING, RE: (07411)
- 11 12-14 x 1 SELF-DRILLER W/WASHER [FASTENER #11] (1 PER RIB) RE: (05500)
- 12 BACKUP PLATE, RE: (07411)
- 13 STEEL DECK (05410)
- 14 METAL VENT MATERIAL, RE: (07411)
- 15 12-14 x 1 SELF-DRILLER W/O WASHER [FASTENER #1A] 2 PER CLIP (07411)
- 16 4" VINYL BACKED INSULATION, RE: (07212)
- 17 10-16 x 1 PANCAKE HEAD SELF-DRILLER [FASTENER #12] (2) @ EACH PURLIN, RE: (07411)
- 18 JOINT SEALANT, RE: (07400)
- 19 HIGH RAKE SUPPORT ANGLE (07411)
- 20 HIGH FLOATING CLIP RE: (07411)
- 21 1/4-14 x 1 1/4 SELF-DRILLER W/O WASHER [FASTENER #1B] (2 PER CLIP), RE: (05500)
- 22 1/4-14 x 1 1/4 LONG-LIFE SELF-DRILLER W/WASHER [FASTENER #1E] @ 24" O.C. RE: (07411)
- 23 METAL PANEL, RE: (07411)
- 24 COUNTERFLASH RE: (07411)
- 25 1/4 x 1 1/4 ANCHOR [FASTENER #1] @24" O.C.
- 26 (PRE-DRILL HOLE) (07411)
- 27 PARAPET RAKE FLASHING RE: (07411)
- 28 EIFS BANDING, RE: (04220)
- 29 MTL. COPING W/ CONCEALED CLIPS, RE: (07552)
- 30 TREATED WOOD WOOD BLOCKING, RE: (06100)
- 31 3" PORTLAND CEMENT PLASTER W/ FINISH COAT RE: (04220) 1/2" ACRYLIC
- 32 WALL LOUVERS, RE: (10210)
- 33 8" COLD-FORMED METAL FRAMING, RE: (05400)
- 34 3/8" GLASS-REINFORCED EXTERIOR GYP. BD, RE: (04260)
- 35 SPRAY-ON INSULATION, RE: (07212)

**PROJECT DESIGN GROUP, LLC**  
300 LAFAYETTE STREET, SUITE 200  
NEW ORLEANS, LOUISIANA 70130  
(504) 523-6472 FAX (504) 529-1181

**SIZELER THOMPSON BROWN ARCHITECTS**

**REK ARCHITECTS, LLC**  
21489 KOOP DRIVE, SUITE 5  
MANDEVILLE, LOUISIANA 70471  
(985) 875-7534 FAX (985) 875-7837

**architects**

revisions		
no.	revision	date

**SLIDELL MUNICIPAL CENTER BUILDING 2**  
SLIDELL, LA

ROOF DETAILS

	file name	drawing number
	project number	51093.02
	date	9-5-09
	phase	CD

A10.2