

1 MECHANICAL CHASE SHALL HAVE A CONCRETE FLOOR AND REQUIRED PENETRATIONS THRU FLOOR SHALL BE FIREPROOFED AS REQUIRED BY CODE.

2 FIRE EXTINGUISHERS, (10523)

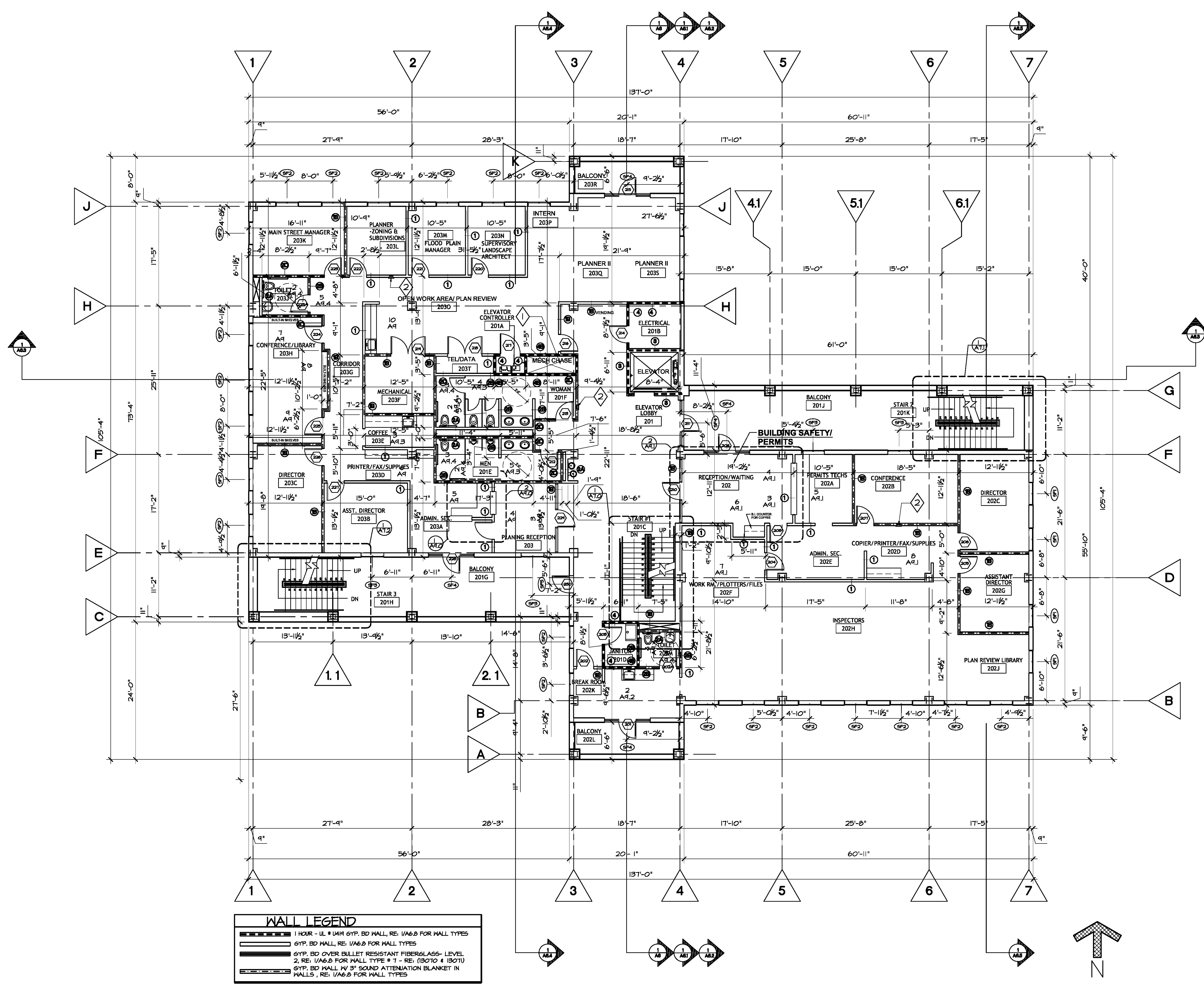

**WALL LEGEND**

	1 HOUR - UL # 1414 GYP. BD WALL, RE. 1/A6.8 FOR WALL TYPES
	GYP. BD WALL, RE. 1/A6.8 FOR WALL TYPES
	GYP. BD OVER BULLET RESISTANT FIBERGLASS- LEVEL 2, RE. 1/A6.8 FOR WALL TYPE # 7 - RE. (13010 & 13071)
	GYP. BD WALL W/ 3" SOUND ATTENUATION BLANKET IN WALLS, RE. 1/A6.8 FOR WALL TYPES

**1. SECOND FLOOR PLAN**  
SCALE: 1/8" = 1'-0"

**PROJECT DESIGN GROUP, LLC**  
300 LAFAYETTE STREET, SUITE 200  
NEW ORLEANS, LOUISIANA 70130  
(504) 523-6472 FAX (504) 529-1181

**SIZELER THOMPSON BROWN ARCHITECTS**

**REK ARCHITECTS, LLC**  
21489 KOOP DRIVE, SUITE 5  
MANDEVILLE, LOUISIANA 70471  
(985) 875-7534 FAX (985) 875-7837

**architects**

revisions		
no.	revision	date

**SLIDELL MUNICIPAL CENTER  
BUILDING 2**  
SLIDELL, LA

**SECOND FLOOR PLAN**

	file name	drawing number
	project number	51093.02
	date	9-5-09
	phase	CD

A2.1