

SPECIFIC NOTES

① ALL CLASS ROOMS SHALL HAVE 2-LEVEL OF ILLUMINATION; OUTBOARD LAMPS ON SWITCH a INBOARD LAMPS ON SWITCH b, PROVIDE TWO BALLAST PER FIXTURE. ONE FOR INBOARD AND THE OTHER FOR OUTBOARD LAMP.

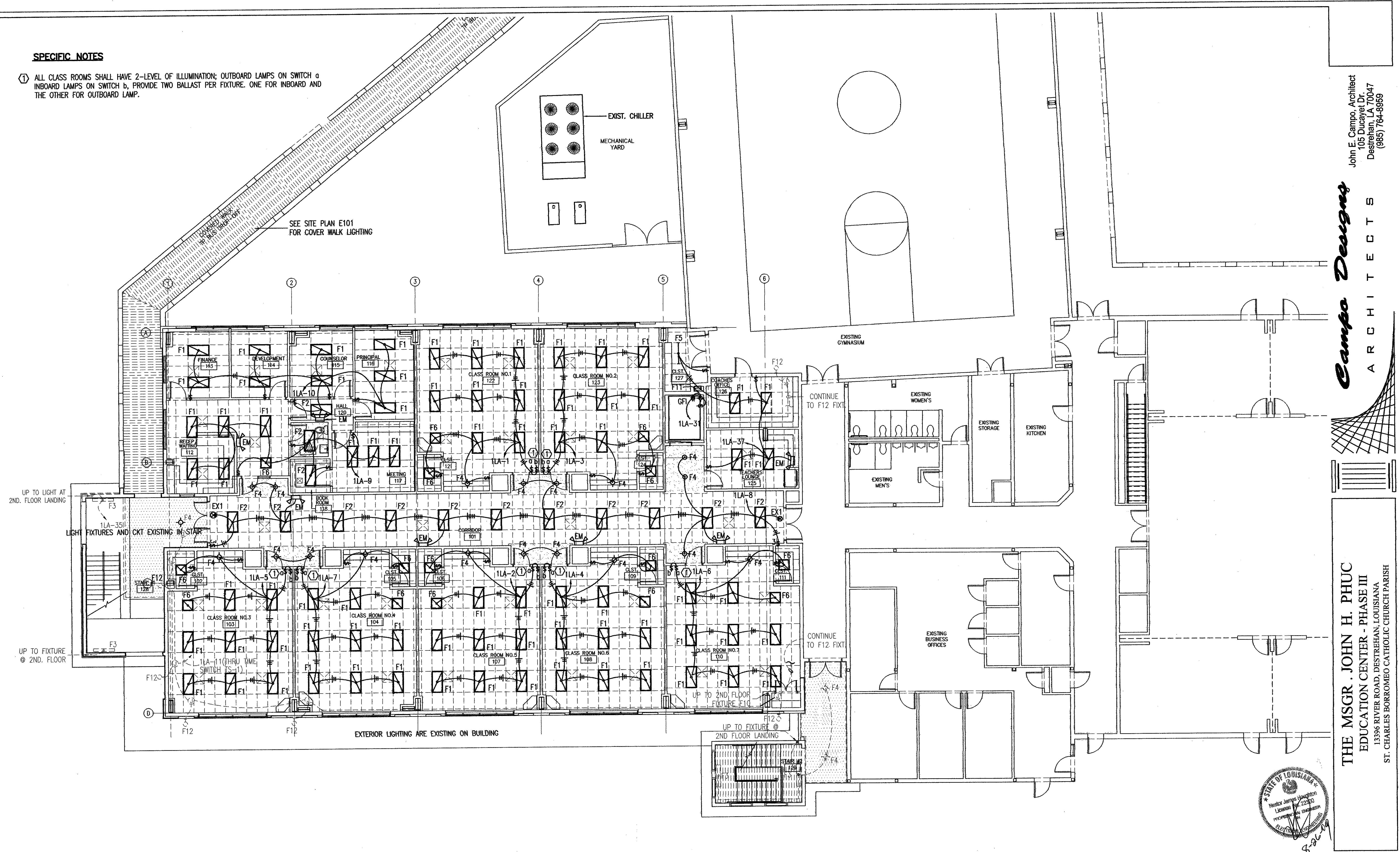

① **FIRST FLOOR PLAN - LIGHTING**
E102 SCALE: 1/8"=1'-0"

John E. Campo, Architect
105 Ducayet Dr.
Destrehan, LA 70047
(985) 764-8959

Campo Designs
ARCHITECTS

THE MSGR. JOHN H. PHUC
EDUCATION CENTER - PHASE III
13396 RIVER ROAD, DESTREHAN, LOUISIANA
ST. CHARLES BORROMEO CATHOLIC CHURCH PARISH



M-K ENGINEERING, INC.
CONSULTING ENGINEERS
HVAC-PLUMBING-FIRE PROTECTION-ELECTRICAL
4323 Division Street, Suite 211
Metairie, LA 70002
Tel:(504) 887-2378, Fax:(504) 887-2302
Email: MKansagra@M-K-E.com
M-K Project No.: 02105

2 OF 8 SHEETS
DATE:
SEPT. 11, 2009
CD-1705