

KEY NOTES:

- ① PROVIDE J.BOX WITH 120V FOR CHILLER CONTROL. VERIFY WITH MANUFACTURER FOR PROPER POWER SOURCES CONTROLS.
- ② MOUNT DISCONNECT SWITCH IN 3" CHANNEL H.D.G. WITH CROSS ARM MEMBERS.
- ③ COMBINATION STARTER NEMA 3R, SIZE 1 FURNISHED BY DIV. 15 INSTALLED BY CONTRACTOR. PROVIDE THE NECESSARY HARDWARE SUPPORT.
- ④ PROVIDE 3" CONCRETE ENCASED AT MINIMUM 24" DEPTH.
- ⑤ EXISTING 1-5" UNDERGROUND SPARE CONDUIT MAY BE USED BY ENTERGY TO UPGRADE THE SERVICE DUE TO INCREASE IN THE NEW CONNECTED LOAD.
- ⑥ LOCATED RECEPTACLE FOR TV'S ADJACENT TO UNIT. PROVIDE TV RACK IF NECESSARY.
- ⑦ PROVIDE TV JACK BOX WITH 1/2" CONDUIT TO CEILING SPACE FOR CABLE TO TV SYSTEM.
- ⑧ PROVIDE COMPUTER BOX WITH 1/2" CONDUIT TO CEILING SPACE FOR COMPUTER CABLE.
- ⑨ ROUTE WIRE TO TOILET ROOM LIGHTS SUCH THAT WHEN LIGHTS ARE ON FAN IS ENERGIZED. PROVIDE 1-2 POLES SWITCH.
- ⑩ ROUTE 1 1/2" CONDUIT FROM EXIST. TELEPHONE BOARD TO NEW TEL. BOARD IN ELECTRICAL ROOM. VERIFY EXACT LOCATION OF EXIST. TEL. BOARD. THE NEW RACEWAY SHALL BE ROUTED THRU EXIST. CEILING SPACE.

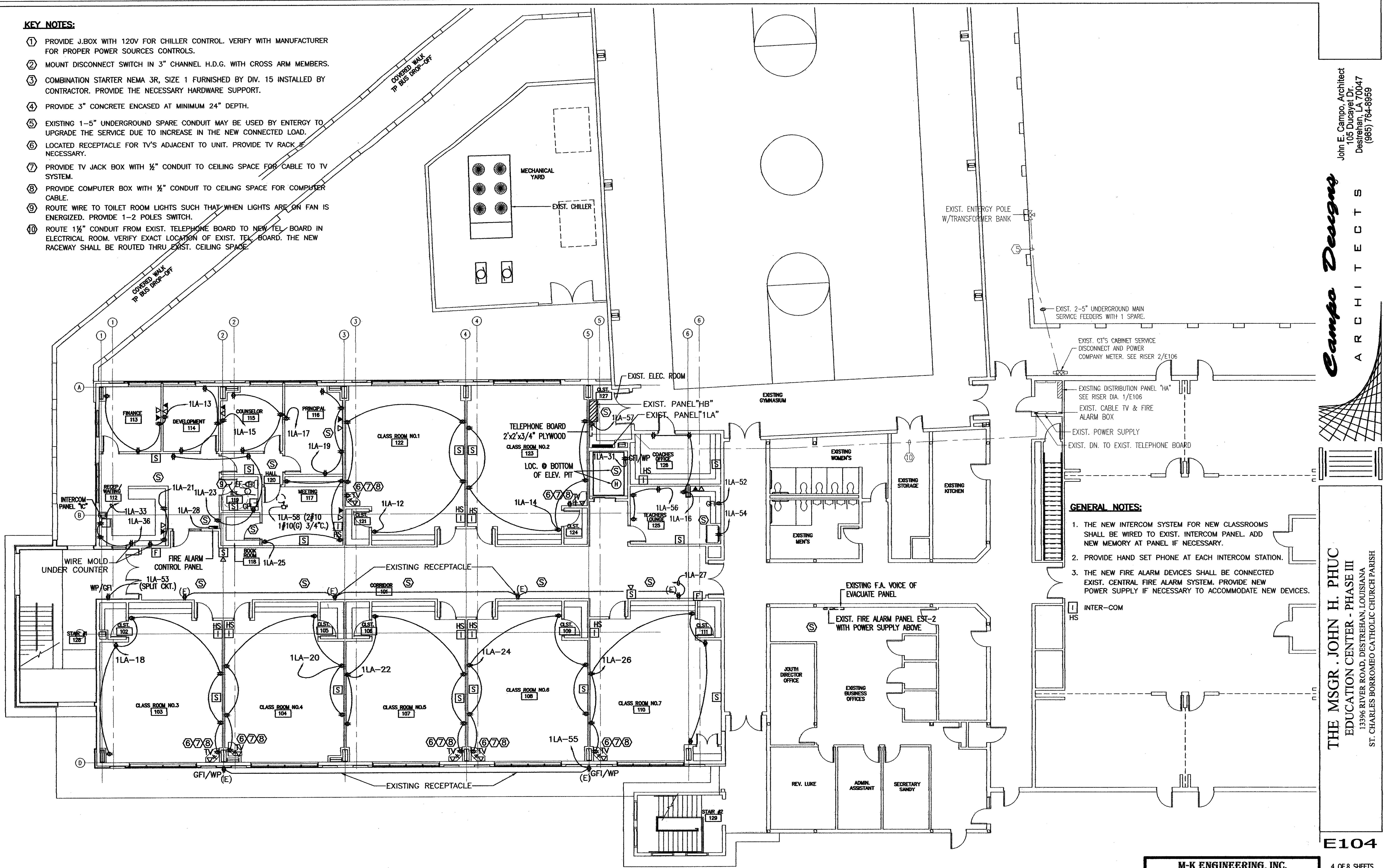

GENERAL NOTES:

1. THE NEW INTERCOM SYSTEM FOR NEW CLASSROOMS SHALL BE WIRED TO EXIST. INTERCOM PANEL. ADD NEW MEMORY AT PANEL IF NECESSARY.
2. PROVIDE HAND SET PHONE AT EACH INTERCOM STATION.
3. THE NEW FIRE ALARM DEVICES SHALL BE CONNECTED EXIST. CENTRAL FIRE ALARM SYSTEM. PROVIDE NEW POWER SUPPLY IF NECESSARY TO ACCOMMODATE NEW DEVICES.

John E. Campo, Architect
105 Ducajtel Dr.
Destrehan, LA 70047
(985) 784-8959

Campo Designs
ARCHITECTS

THE MSGR. JOHN H. PHUC
EDUCATION CENTER - PHASE III
13396 RIVER ROAD, DESTREHAN, LOUISIANA
ST. CHARLES BORROMEO CATHOLIC CHURCH PARISH

1 FIRST FLOOR PLAN - POWER & SPECIAL SYSTEM
E104 SCALE: 1/8" = 1'-0"

M-K ENGINEERING, INC.
CONSULTING ENGINEERS
HVAC-PLUMBING-FIRE PROTECTION-ELECTRICAL
4323 Division Street, Suite 211
Metairie, LA 70002
Tel:(504) 887-2376, Fax:(504) 887-2302
Email: MKansagra@M-K-E.com
M-K Project No.: 02105

4 OF 8 SHEETS
DATE: SEPT. -11, 2009
CHECKED BY: MK
DRAWN BY: JG

E104