

PRENTISS AVE.

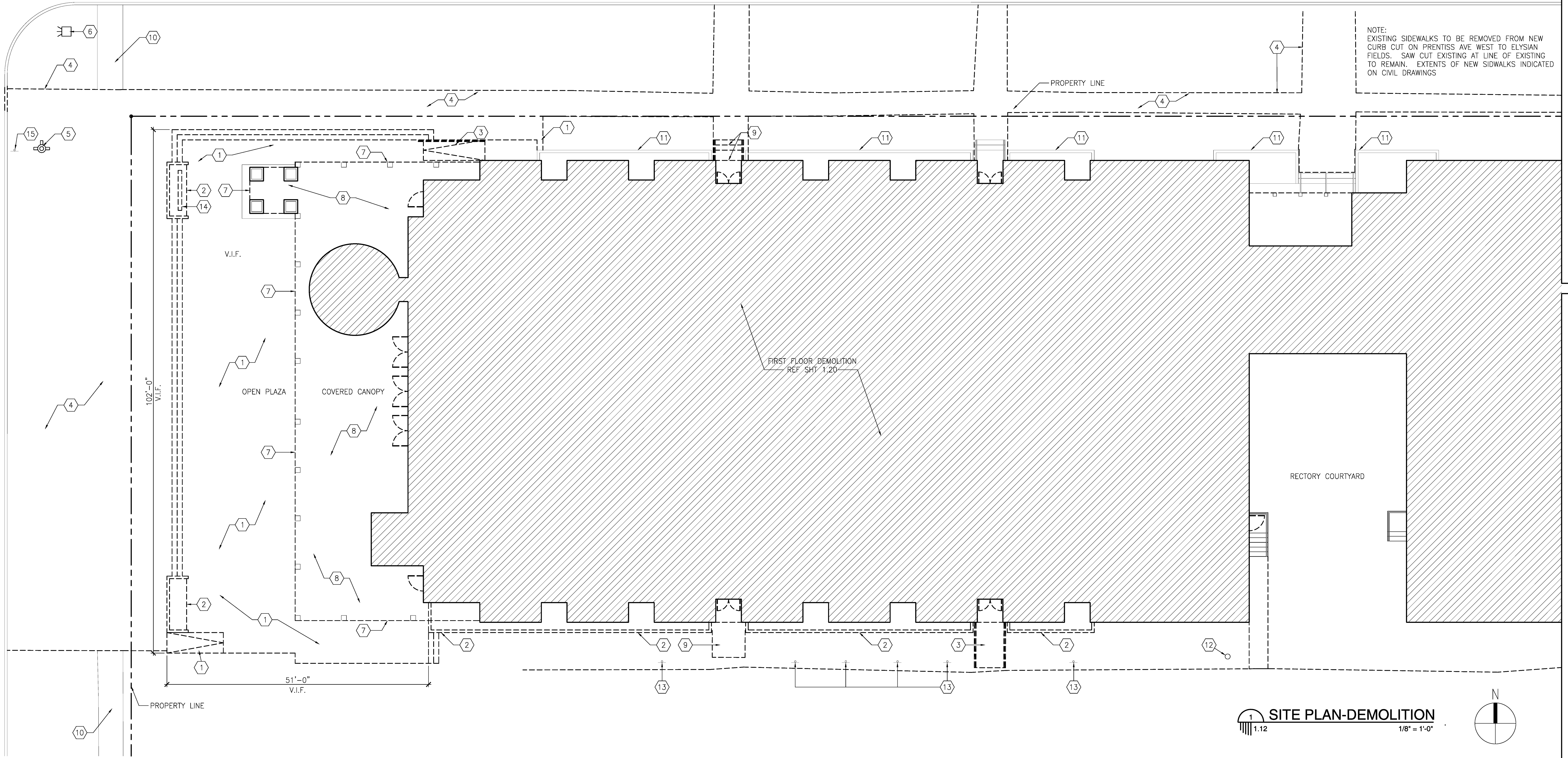

NOTE:  
EXISTING SIDEWALKS TO BE REMOVED FROM NEW CURB CUT ON PRENTISS AVE WEST TO ELYSIAN FIELDS. SAW CUT EXISTING AT LINE OF EXISTING TO REMAIN. EXTENTS OF NEW SIDEWALKS INDICATED ON CIVIL DRAWINGS

**SITE PLAN-DEMOLITION**  
1.12  
1/8" = 1'-0"

**CLARIFICATION OF REFERENCE DESIGNATIONS**

- ① DEMOLISH EXISTING REINFORCED CONCRETE PLAZA SLAB AND STEPS AS INDICATED; EXISTING PILES ARE TO REMAIN. REF STRUCTURAL DRAWINGS.
- ② DEMOLISH CONCRETE PLANTER
- ③ DEMOLISH CONCRETE RAMP, HANDRAILS, AND CURB. SAW CUT CONCRETE IN-LINE WITH BRICK FACE.
- ④ DEMOLISH CONCRETE SIDEWALK AND PAVEMENT; CURB TO REMAIN
- ⑤ EXISTING FIRE HYDRANT TO REMAIN
- ⑥ EXISTING TRAFFIC LIGHT TO REMAIN
- ⑦ SAW CUT EXISTING PLAZA SLAB AT THIS LOCATION
- ⑧ CONCRETE PLAZA SLAB BELOW CANOPY TO REMAIN
- ⑨ DEMOLISH CONCRETE STEPS AND/OR RAMP. SAW CUT CONCRETE AS INDICATED.
- ⑩ EXISTING CONCRETE WALK TO REMAIN
- ⑪ EXISTING CONCRETE PLANTER TO REMAIN
- ⑫ DEMOLISH SITE LIGHTING POLE
- ⑬ DEMOLISH ACCESSIBLE PARKING SIGNS
- ⑭ DEMOLISH SIGN
- ⑮ MAINTAIN RTA BUS STOP SIGN THROUGH-OUT CONSTRUCTION PROCESS

ARCHITECTURE  
ENVIRONMENTS  
URBAN DESIGN

Eskew+Dumez+Ripple

**TRANSFIGURATION OF THE LORD**  
CHURCH RENOVATIONS

2211 PRENTISS AVENUE  
NEW ORLEANS, LOUISIANA 70122

Date: 7 JULY 2010

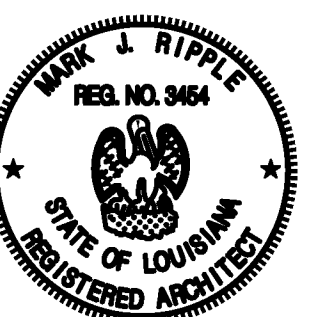

E+D+R No. 09007  
Drawn By: MARTIN  
Drawing Title:  
SITE PLAN-  
DEMOLITION

Sheet No: