

1 SECOND FLOOR PLAN
1/8" = 1'-0"

CLARIFICATION OF REFERENCE DESIGNATIONS

NOTE: 1. AT ALL EQUIPMENT, FINISHES, DEVICES, ETC. TO BE REMOVED; REMOVE ALL ANCHORING DEVICES AND FITTINGS. PATCH, FILL, AND REPAIR OPENINGS LARGER THAN 6"x8" TO MATCH ADJACENT EXISTING CONSTRUCTION. PROVIDE COVER PLATE AT OPENINGS UP TO 6"x8".

- ① GYPSUM BOARD ON METAL FURRING (NAVE SIDE ONLY). ON CHOIR LOFT SIDE, EXISTING WOOD PANEL AND CAP RAIL TO REMAIN.
- ② ELECTRIC PANEL REFER TO ELECTRICAL
- ③ REPLACE DAMAGED AND LEAKING PORTION OF ROOF DRAIN ASSEMBLY
- ④ REMOVE DUCT PENETRATIONS, INFILL MASONRY WALL WITH 1 HR. RATED PARTITION U.L.-U419
- ⑤ STATUARY BY OWNER
- ⑥ 1 HR. RATED SHAFT WALL ASSEMBLY U.L.-U408
- ⑦ 1 HR. RATED PARTITION FROM CONCRETE SLAB TO STRUCTURE ABOVE U.L.-U419

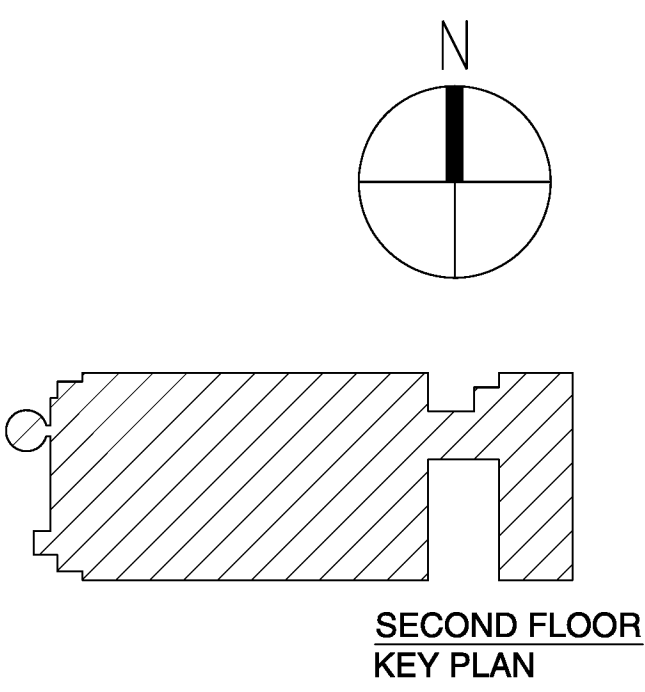

P:\2009_Projects\09007_101L Church Drawings\02Plans\0202_SecondFloorPlan.dwg
07 Jul 10 - 11:07am