

5 NORTH ELEVATION
2.1 | 8.1 AT WOOD WALL
1/4" = 1'-0"

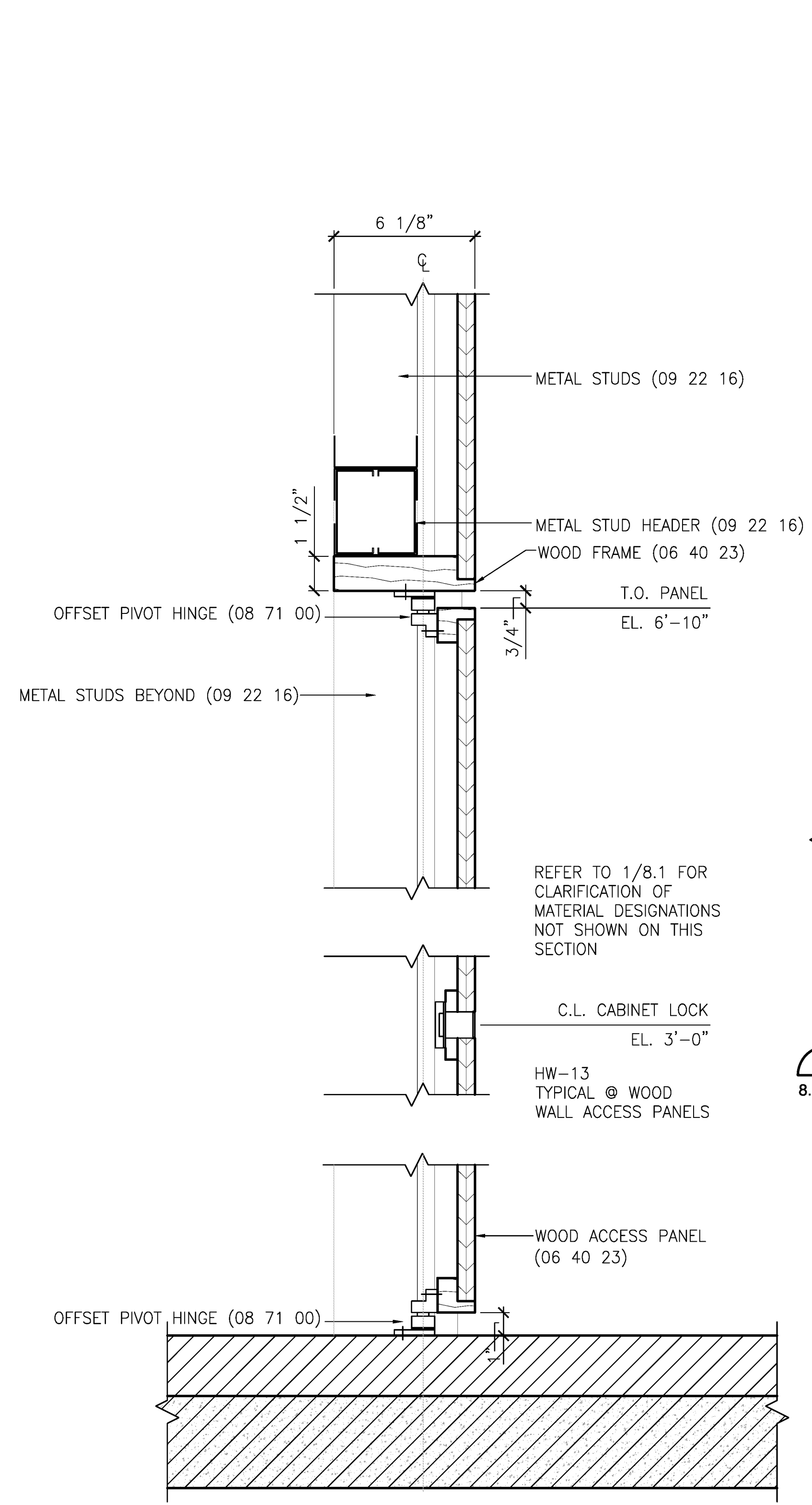

4 SECTION THRU WOOD WALL
8.1 | 8.1 AT WOOD WALL ACCESS PANEL
3" = 1'-0"

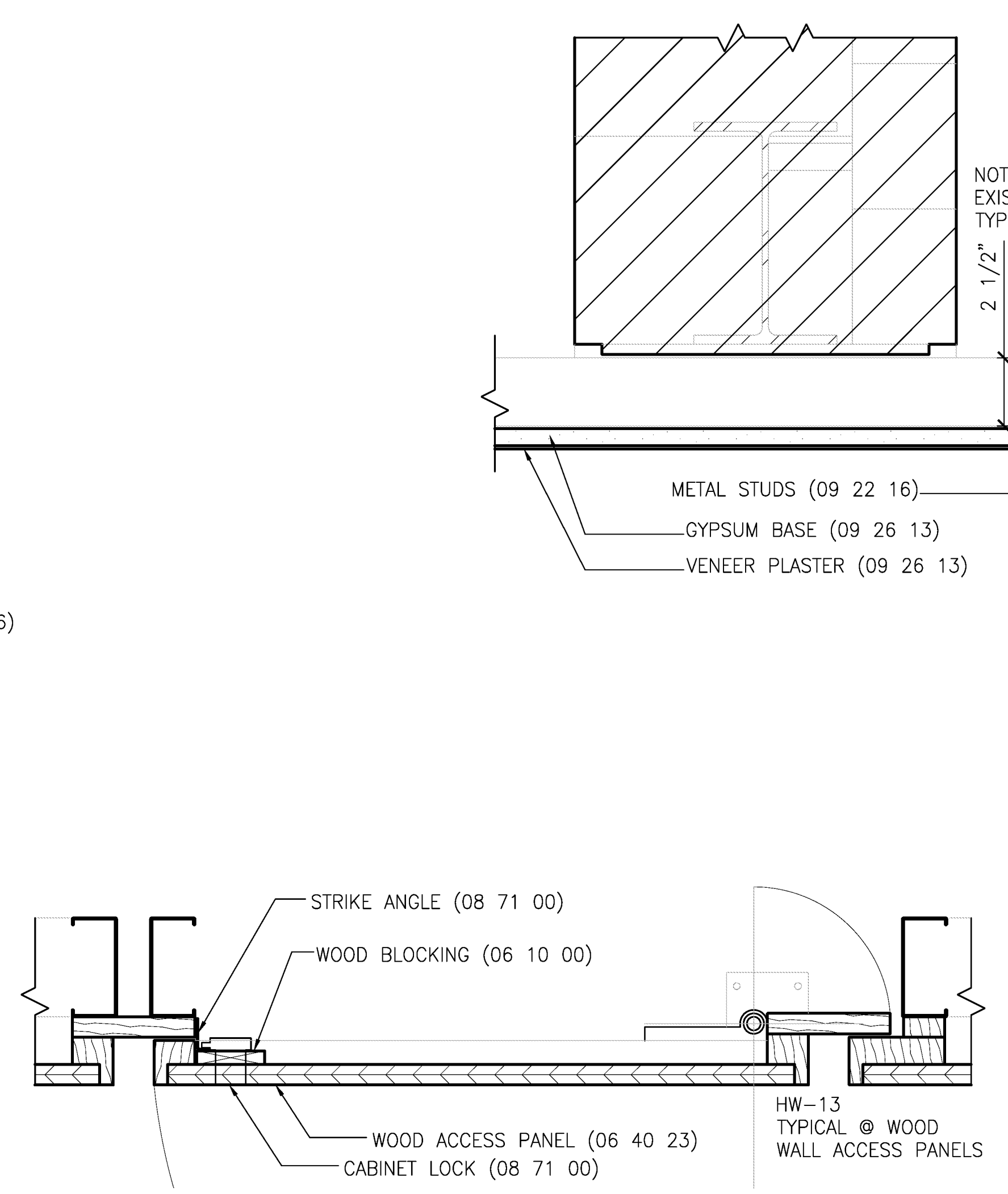

3 HORIZONTAL SECTION THRU WOOD WALL
8.1 | 8.1 AT WOOD WALL ACCESS PANELS
3" = 1'-0"

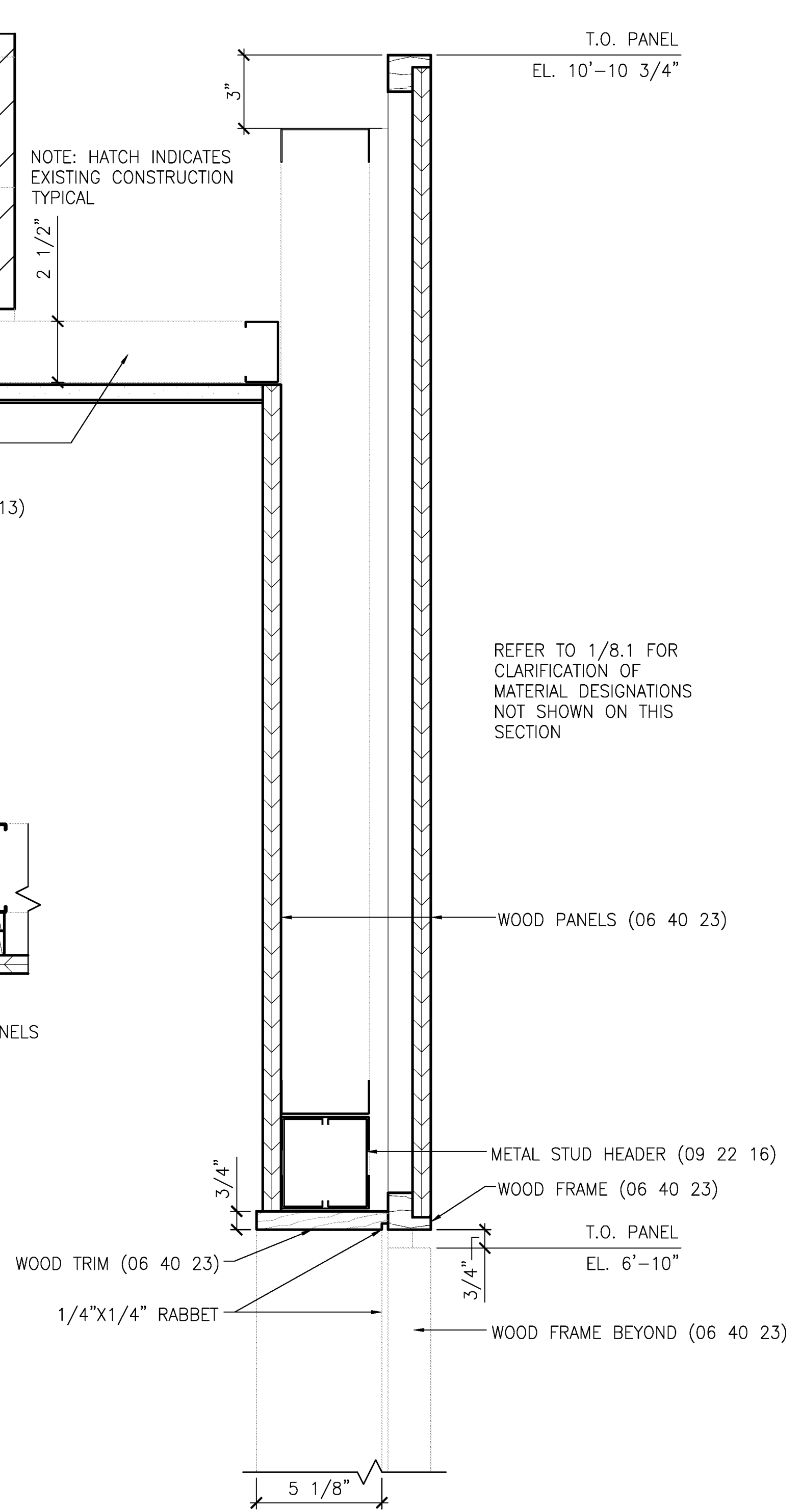

2 SECTION THRU WOOD WALL
8.1 | 8.1 AT MARY CHAPEL
3" = 1'-0"

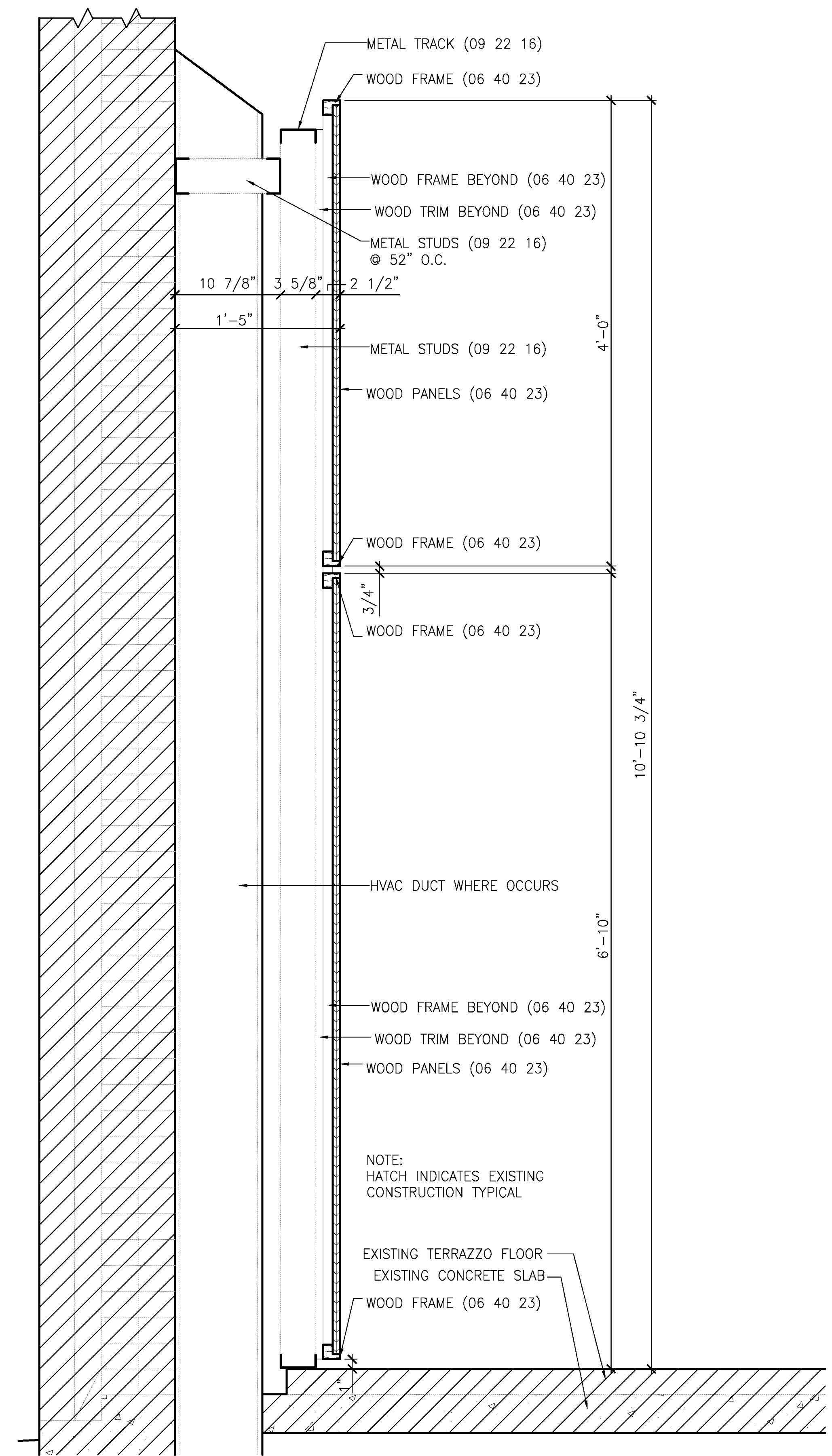

1 SECTION THRU WOOD WALL
8.1 | 8.1 AT HVAC
1 1/2" = 1'-0"

P:\2009_P\Projects\09007_TOTL Church\Drawings\0Interior\0801_Int Elevations.dwg
07 Jul 10 - 11:02am

Date: 7 JULY 2010



E+D+R No. 09007
Drawn By: WEST
Drawing Title:
INTERIOR ELEVATIONS

Sheet No: