

| | |
|-------------|------------|
| project no. | 20-0901 |
| drawn | ENG |
| checked | JJP |
| date | 01.18.2010 |
| revised | |

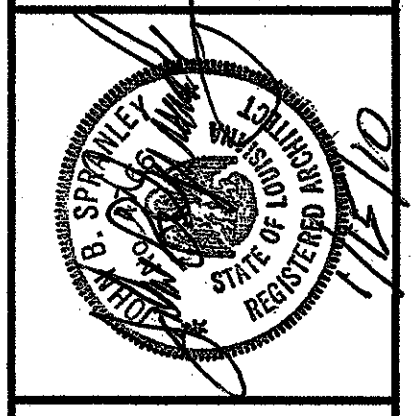

MEYER ENGINEERS, LTD.
ENGINEER & ARCHITECT

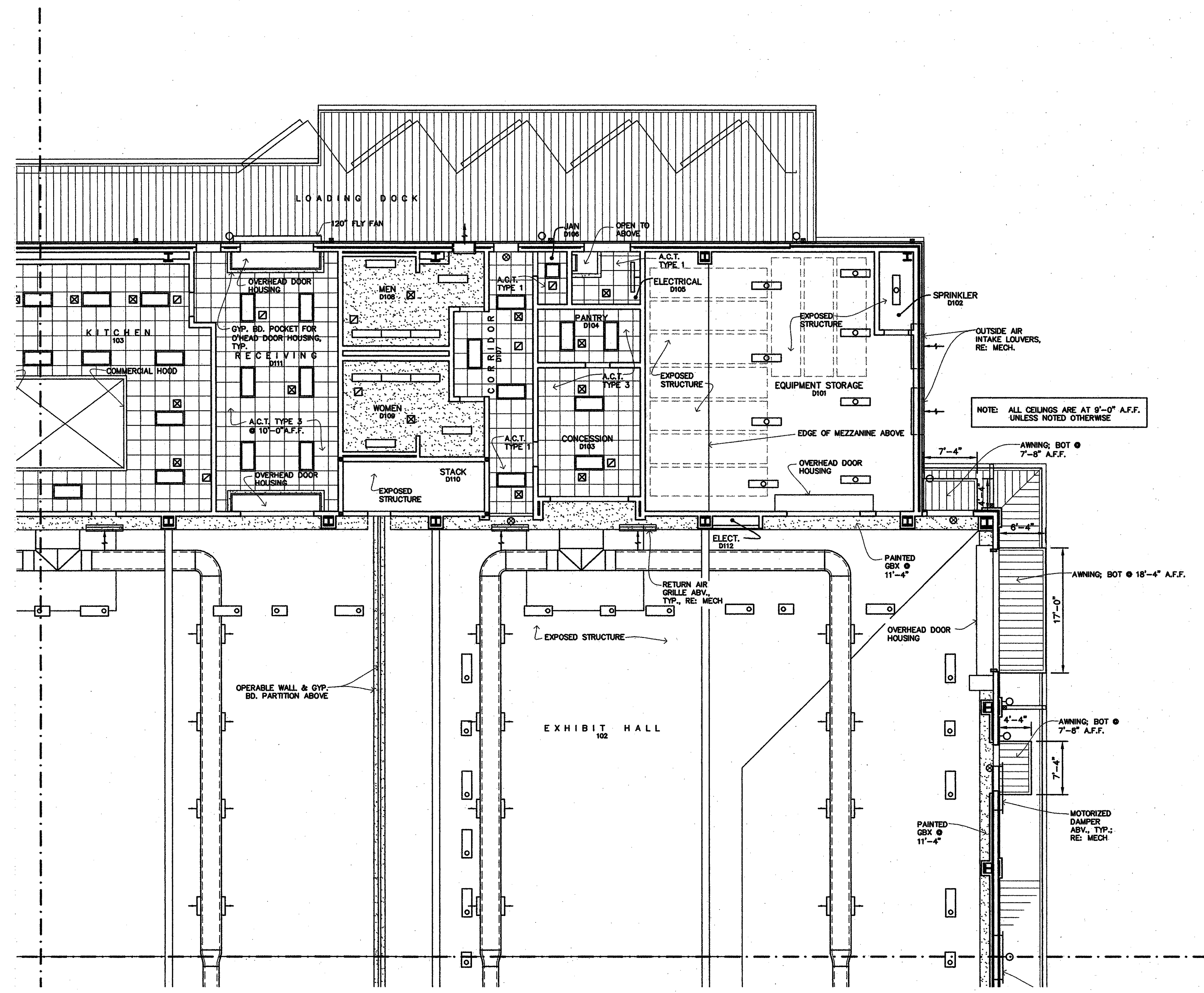

- CEILING LEGEND**
- 2' x 2' SUSPENDED ACOUSTICAL TILE CEILING
 - 5/8" GYPSUM BOARD CEILING AND SUSPENSION SYSTEM - ACCESS PANEL LOCATIONS, RE: MECH. (SEE 11/A7.4)
 - PRE-FINISHED METAL SOFFIT PANELS AND SUSPENSION SYSTEM
 - WALL MOUNTED LIGHT FIXTURE; RE: ELECTRICAL LIGHTING PLAN
 - 2x4 LAY-IN LIGHT FIXTURE; RE: ELECTRICAL LIGHTING PLAN
 - SUSPENDED LIGHT FIXTURE; RE: ELECTRICAL LIGHTING PLAN
 - SURFACE MOUNTED LIGHT FIXTURE; RE: ELECTRICAL LIGHTING PLAN
 - HI-BAY SUSPENDED LIGHT FIXTURE; RE: ELECTRICAL LIGHTING PLAN
 - HI-BAY SUSPENDED LIGHT FIXTURE; RE: ELECTRICAL LIGHTING PLAN
 - WALL MOUNTED LIGHT FIXTURE; RE: ELECTRICAL LIGHTING PLAN
 - ILLUMINATED EXIT SIGN, RE: ELECTRICAL LIGHTING PLAN
 - SIDE WALL SUPPLY AIR DIFFUSER, RE: HVAC PLAN
 - EXHAUST / RETURN GRILL, TYP.; RE: HVAC PLAN
 - SUPPLY DIFFUSER, TYP.; RE: HVAC PLAN

1 AREA 'D' CEILING PLAN
A2.9 | A2.9
1/8" = 1'-0"

AREA 'B' CEILING PLAN
VAL RISS PARK
MULTI-PURPOSE BUILDING
ST. BERNARD PARISH, OWNER

sheet no.
A29
of ___ sheets