

T:\CAD\PROJ\2900\S\2910\E\_PWR.dwg, 1/12/2010 5:43:08 PM, REV

GVA PROJECT No  
2910  
CADD FILE  
E\_PWR  
LAST REVISION  
01-12-10  
PLOT DATE  
01-12-10  
PLOT SCALE  
1=1

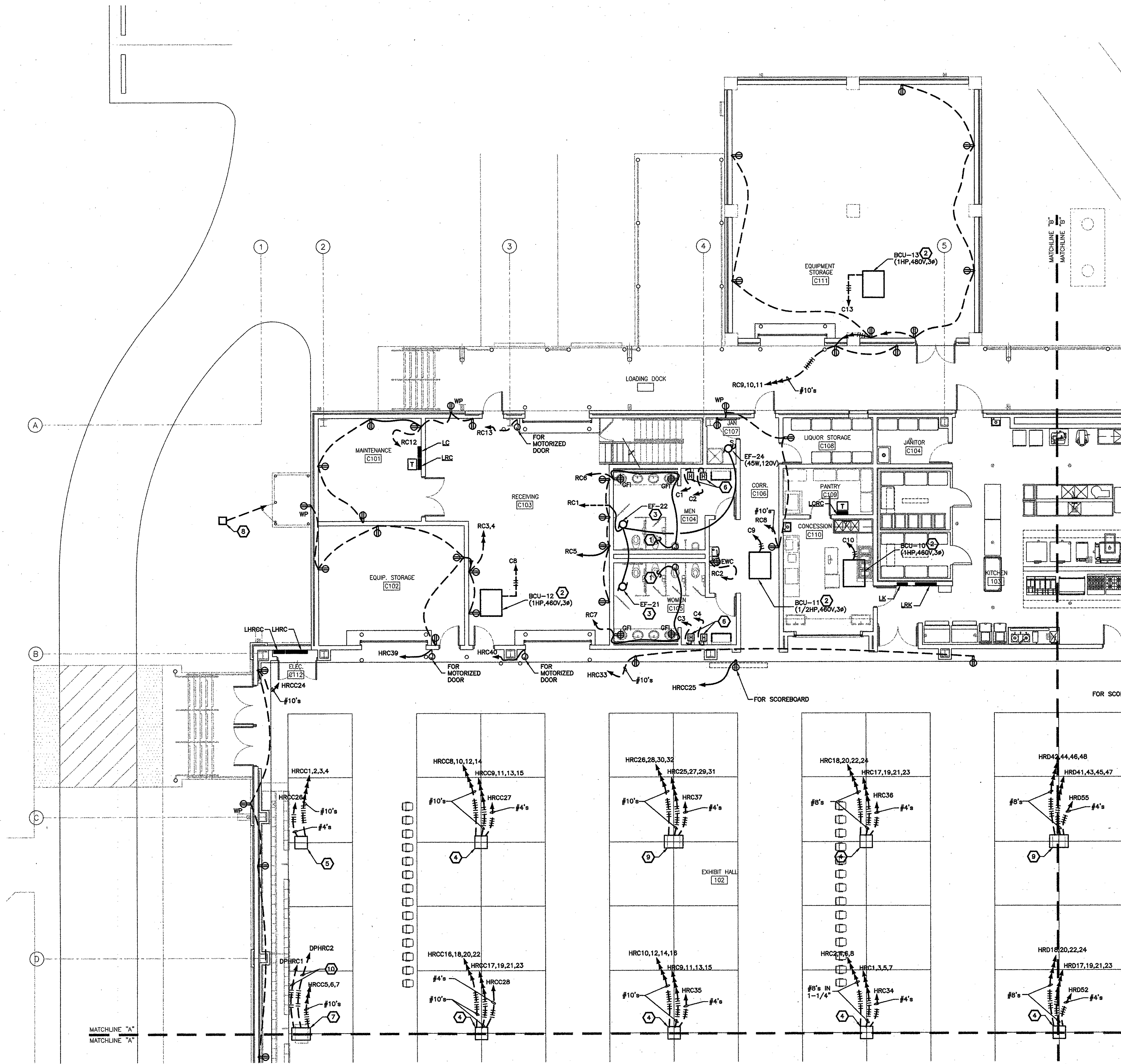

POWER  
PARTIAL FLOOR PLAN  
SCALE : 1/8" = 1'-0"

**SPECIFIC NOTES:**

- 1 CONNECT TO 24V TRANSFORMER FOR FLUSH VALVE SOLENOIDS AND SENSORS FOR WATER CLOSETS AND URINALS.
- 2 MECHANICAL EQUIPMENT WITH INTEGRAL MOTOR CONTACTOR, OVERLOAD PROTECTION AND DISCONNECT. ROUTE 3#12, 1#12(G) IN 3/4" TO DESIGNATED PANEL.
- 3 EXHAUST FAN WITH FRACTIONAL HORSEPOWER MOTOR. PROVIDE NECESSARY RELAYS AND CONTACTORS TO CONTROL EXHAUST FAN WITH AUTOMATIC LIGHTING SHUTOFF DEVICE IN ROOM.
- 4 PROVIDE A LARGE CAPACITY FLOOR BOX TYPE 1. EACH RECEPTACLE SHALL BE ON ITS OWN DEDICATED CIRCUIT. SEE SPECIFICATIONS AND DETAILS FOR ADDITIONAL INFORMATION.
- 5 PROVIDE A LARGE CAPACITY FLOOR BOX TYPE 2. EACH RECEPTACLE SHALL BE ON ITS OWN DEDICATED CIRCUIT. SEE SPECIFICATIONS AND DETAILS FOR ADDITIONAL INFORMATION.
- 6 ELECTRICAL HAND DRYER. APPROX 2300W, 277V, 1Ø.
- 7 PROVIDE A LARGE CAPACITY FLOOR BOX TYPE 3. EACH RECEPTACLE SHALL BE ON ITS OWN DEDICATED CIRCUIT. SEE SPECIFICATIONS AND DETAILS FOR ADDITIONAL INFORMATION.
- 8 PROVIDE 12"W X 12"L X 10"D PRECAST HANDHOLE AND 2" EMPTY CONDUIT W/ PULLSTRING TO PANEL LRA.
- 9 PROVIDE A LARGE CAPACITY FLOOR BOX TYPE 4. EACH RECEPTACLE SHALL BE ON ITS OWN DEDICATED CIRCUIT. SEE SPECIFICATIONS AND DETAILS FOR ADDITIONAL INFORMATION.
- 10 #600,1#2(G) IN 4", AND 2 #12'S TO SHUNT TRIP ON BREAKER.

**NOTES:**

- 1 REFER TO ARCHITECTURAL AND STRUCTURAL DRAWINGS FOR ADDITIONAL INFORMATION OF FLOOR BOX LOCATIONS AND INSTALLATION.
- 2 PROVIDE (1) WEATHER PROTECTED DUPLEX RECEPTACLE MOUNTED AT WALL BY DUMPSTERS FOR DOMESTIC WATER PIPE HEAT TRACE. REFER TO PLUMBING DRAWINGS FOR EXACT LOCATION. ROUTE #10'S UNDER GROUND TO LRC14.

project no. 20-0901  
drawn GVT  
checked LRP  
date 01.15.2010  
revised 00.00.0000

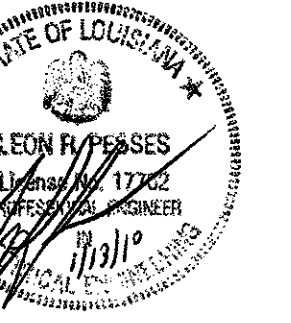

**MEYER ENGINEERS, LTD.**  
ENGINEER & ARCHITECT

AREA 'C' FLOOR PLAN - POWER  
VAL RIESS PARK  
MULTI-PURPOSE BUILDING  
ST. BERNARD PARISH, OWNER

sheet no.  
**E23**  
of \_\_\_ sheets

**GVA ENGINEERING, L.L.C.**  
PROJECT No. 2910