

project no. 20-0901  
 drawn GVT  
 checked LRP  
 date 01.15.2010  
 revised 00.00.0000  
 00.00.0000

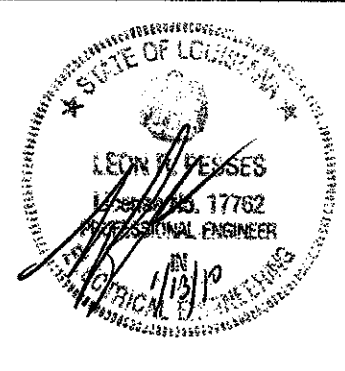

**MEYER ENGINEERS, LTD.**  
**ENGINEER & ARCHITECT**

AREA 10' FLOOR PLAN - SPECIAL SYSTEMS  
 VAL RISS PARK  
 MULTI-PURPOSE BUILDING  
 ST. BERNARD PARISH, OWNER

sheet no.  
**E3.4**  
 of \_\_\_ sheets

**NOTES:**

1. REFER TO ARCHITECTURAL AND STRUCTURAL DRAWINGS FOR ADDITIONAL INFORMATION OF FLOOR BOX LOCATIONS AND INSTALLATION.
2. PROVIDE PROTECTIVE CAGES ON WALL MOUNTED DEVICES IN EXHIBIT HALL.

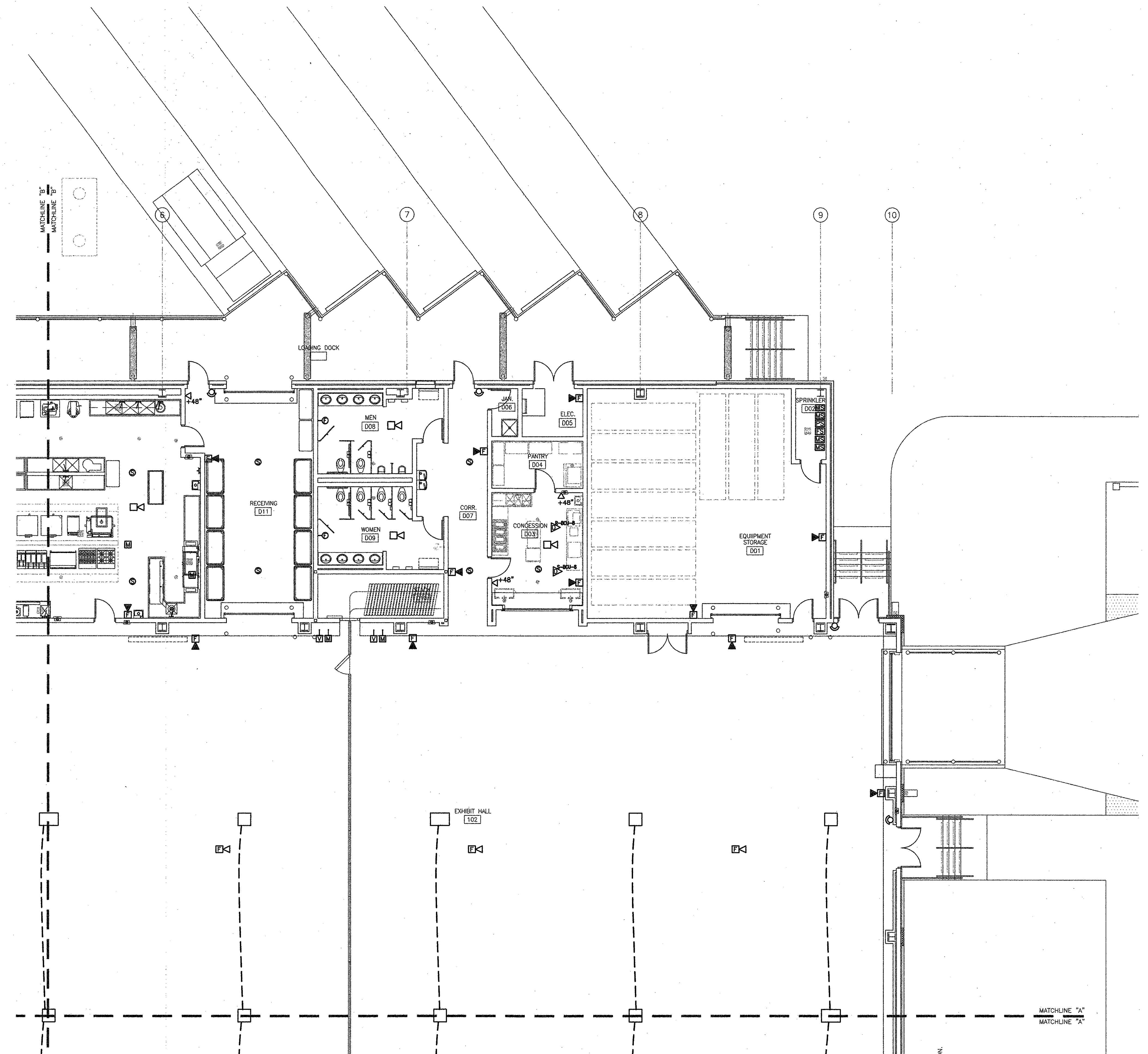

**SPECIAL SYSTEMS**  
**PARTIAL FLOOR PLAN**  
 SCALE : 1/8" = 1'-0"

GVA PROJECT No. 2910  
 CAD FILE  
 F SS  
 LAST REVISION  
 01-13-10  
 PLOT DATE  
 01-13-10  
 PLOT SCALE  
 1=1

**GVA ENGINEERING, L.L.C.**  
 PROJECT No. 2910

T:\CADPROJ\2900\2910\1\_FLOOR\_SS.dwg, 1/13/2010 9:23:58 AM, gvt