

MECHANICAL ROUGH-IN DATA SCHEDULE

CONN. NO.	ITEM NO.	UTILITY REQUIREMENTS	NOTES	CONN. NO.	ITEM NO.	UTILITY REQUIREMENTS	NOTES
P-1		FD-A (AREA CLEAN-UP FLOOR DRAIN)		P-33	46/59	SODA LINES (BY SYRUP VENDOR) DFA FOR SYRUP/CO2 LINES RUN ABOVE FINISHED CEILING FROM SYRUP STORAGE RACK TO SODA GUNS	
P-2	1	1/2" H & CW 36" AFF	7	P-34	53	FD-B FOR DROP-IN HOT FOOD UNIT	25
P-3	1	2" IPS PIPE DRAIN 2-3/4" AFF TO FIT MOP SINK		P-35	55	1/2" H & CW 18" AFF FOR HAND SINK	7
P-4	3	3/4" TYPE "L" COPPER CONDENSATE DRAIN LINE FROM WALK-IN COOLER/FREEZER EVAPORATOR COILS TO FLOOR MOP SINK - DIVISION 11	9,26	P-36	55	1-1/2" DR 24-1/2" AFF FOR HAND SINK	7
P-5	8	1/2" H & CW 18" AFF FOR HAND SINK	7	P-37	57	1/2" H & CW 18" AFF FOR 3-COMPARTMENT SINK	7
P-6	8	1-1/2" DR 24-1/2" AFF FOR HAND SINK	7	P-38	57	FS (3 CONNECTIONS) FOR 3-COMPARTMENT SINK	7,8
P-7	9	1/2" H & CW 36" AFF FOR FAUCET (DIVISION 15)	10	P-39	58	1/2" CW 60" AFF FOR ICE MACHINE	21
P-8	14	1/2" H & CW 18" AFF FOR 3-COMPARTMENT SINK	7	P-40	58	FD-B FOR ICE MACHINE	22
P-9	14	1/2" H & CW 18" AFF FOR PRE-RINSE SPRAY UNIT OF 3-COMPARTMENT SINK	7	M-1	28	10" X 18" EXHAUST DUCT CONNECTION 9'-6" AFF - 2,200 CFM EACH AT .78" SP	27,28
P-10	14	FS (3 CONNECTIONS) FOR 3-COMPARTMENT SINK	7,8	M-2	28	10" X 30" SUPPLY DUCT CONNECTION 9'-6" AFF - 1,760 CFM EACH AT .25" SP	27,29,30
P-11	15	1/2" CW 18" AFF FOR DISPOSER	11	M-3	33	12" X 12" DISHWASHER CONDENSATE EXHAUST DUCT CONNECTION 6" ABOVE FINISHED CEILING - 600 CFM	27,31,32
P-12	15	2" DR 9" AFF FOR DISPOSER	13				
P-13	16	1/2" H & CW 6" AFF FOR PREPARATION COUNTER W/SINKS	7				
P-14	16	FS (2 CONNECTIONS) FOR PREP COUNTER W/SINKS	7,8				
P-15	16	FS FOR PREP COUNTER W/SINK	7,8				
P-16	20	FS FOR CONVECTION STEAMER	14				
P-17	22	3" DRAIN PIPE FOR STAINLESS STEEL FLOOR DRAIN TROUGH - REFER TO DETAIL "H" & "I", SHEET FS2.0					
P-18	27	3/4" H & CW DFA FOR UDS	15,16				
P-19	27	2" NAT'L GAS DFA FOR UDS - 1,361,000 BTU/HR AT 7" WC PRESSURE FOR UDS	17,18				
P-20	30	1/2" H & CW 18" AFF FOR PRE-RINSE SPRAY UNIT OF SOILED DISHTABLE	7				
P-21	30	1/2" CW FOR SCRAP TROUGH WATER INLET OF SOILED DISHTABLE - WATER PIPING EXTENDED FROM DISPOSER CONTROL PANEL	5,12				
P-22	31	1/2" CW 24" AFF FOR DISPOSER	11,12				
P-23	31	2" DR 9" AFF FOR DISPOSER	13				
P-24	32	1/2" HW (140 DEGREES MINIMUM) 18" AFF FOR DISHWASHER W/INTEGRALLY MOUNTED BOOSTER HEATER - 138 GPH AT 20 PSI	19				
P-25	32	FS FOR DISHWASHER	20				
P-26	37	1/2" CW 84" AFF FOR ICE MACHINE	21				
P-27	37	FD-B FOR ICE MACHINE	22				
P-28	39	1/2" H & CW 18" AFF FOR BEVERAGE COUNTER W/SINK	7				
P-29	39	FS FOR BEVERAGE COUNTER W/SINK AND DRAIN TROUGH	8,23				
P-30	40/41	1/2" CW 44" AFF FOR COFFEE URN AND TEA BREWER					
P-31	45	FD-B FOR ICE BIN	24				
P-32	46	1/2" CW FOR SODA GUN AND CARBONATOR BY SYRUP VENDOR					

- MECHANICAL ROUGH-IN NOTES**
- ROUGH-IN PLAN SHOWS DIMENSIONED LOCATIONS FROM FINISHED WALLS AND/OR CENTER-LINE OF COLUMNS FOR UTILITY REQUIREMENTS OF FOOD SERVICE EQUIPMENT SPECIFIED (INCLUDING NIC EQUIPMENT) PLUS AREA CLEAN-UP FLOOR DRAINS. CONTRACTOR SHALL VERIFY ACCURACY OF DIMENSIONED LOCATIONS.
 - WHERE POSSIBLE, ALL PLUMBING LINES SHALL EXTEND UP THROUGH AND OUT OF BUILDING WALLS.
 - EXTEND AND CONNECT ALL PLUMBING LINES TO CONNECTION POINTS OF FOOD SERVICE EQUIPMENT - DIVISION 15.
 - FURNISH AND INSTALL LINE SHUT-OFF VALVES ON ALL PLUMBING LINES AT EACH FIXTURE - DIVISION 15.
 - EXTEND WATER LINES THROUGH VACUUM BREAKERS (FURNISHED BY DIVISION 11) WHERE INLETS ARE SUBJECT TO SUBMERSION - DIVISION 15.
 - FURNISH WATER INLET VALVES, TEMPERATURE GAUGES, PRESSURE REDUCING VALVES (FOR LOWER PRESSURES THAN INDICATED ON DRAWINGS), MIXING VALVES, AND ACCESSORIES REQUIRED FOR OPERATION OF EQUIPMENT. - DIVISION 11
 - FURNISH SINK FAUCETS, TAIL PIECES, LEVER HANDLE DRAINS AND VACUUM BREAKERS - DIVISION 11.
 - FURNISH AND INSTALL 2" DRAIN LINE EXTENSIONS FROM SINK REQUIRING OPEN SITE DRAINS TO BUILDING FLOOR SINK - DIVISION 15. 2" AIR-GAP REQUIRED.
 - SLOPE CONDENSATE DRAIN LINES GENEROUSLY FROM WALK-IN COOLER AND FREEZER COILS TO 12" ABOVE WALK-IN FLOOR AND EXTEND THROUGH WALK-IN PANELS AND BUILDING WALLS (WHERE APPLICABLE) TO TOP OF MOP SINK - DIVISION 11. DRAIN LINE TRAP AND 2" AIR-GAP REQUIRED.
 - FURNISH AND INSTALL MIXING FAUCET WITH VACUUM BREAKER AND HOSE THREADS - DIVISION 15.
 - EXTEND WATER LINE FROM SOLENOID VALVE AND VACUUM BREAKER TO DISPOSER CONE AND BASE OF DISPOSER -

- DIVISION 15.
- FURNISH AND INSTALL 1/2" (MINIMUM) COLD WATER PIPING FROM SOLENOID VALVE OF DISPOSER TO WATER INLET OF SCRAP TROUGH - DIVISION 15.
- DRAIN LINES OF DISPOSERS SHALL BE RIGIDLY CONNECTED TO DRAINAGE SYSTEM IN ACCORDANCE WITH APPLICABLE PLUMBING CODES.
- FURNISH AND INSTALL 2-1/2" DRAIN LINE FROM CONVECTION STEAMER TO FLOOR SINK - DIVISION 15. 2" AIR-GAP REQUIRED.
- TEST INTERNAL WATER PIPING OF UDS (FURNISHED BY DIVISION 11) FOR LEAKS CAUSED BY SHIPPING AND TIGHTEN AS REQUIRED - DIVISION 15.
- CONNECT THREE (3) WATER QUICK-DISCONNECT HOSE ASSEMBLIES (FURNISHED BY DIVISION 11) TO COOKING EQUIPMENT - DIVISION 15.
- INSTALL MECHANICAL GAS SHUT-OFF VALVE (FURNISHED BY DIVISION 11) OF FIRE EXTINGUISHING SYSTEM ON INCOMING GAS LINE TO UDS - DIVISION 15.
- CONNECT EIGHT (8) GAS QUICK-DISCONNECT HOSE ASSEMBLIES (FURNISHED BY DIVISION 11) TO COOKING EQUIPMENT - DIVISION 15.
- DISHWASHER SPECIFIED INCLUDES INTEGRALLY CONNECTED ELECTRIC WATER BOOSTER HEATER.
- FURNISH AND INSTALL 2" DRAIN LINE FROM DISHWASHER TO FLOOR SINK - DIVISION 15. 2" AIR-GAP REQUIRED.
- INSTALL WATER FILTER FURNISHED WITH ICE MACHINE (DIVISION 11) ON INCOMING WATER LINE TO ICE MACHINE.
- FURNISH AND INSTALL 1/2" AND 1" DRAIN LINE FROM ICE MACHINE AND STORAGE BIN TO FLOOR DRAIN - DIVISION 15. 2" AIR-GAP REQUIRED.
- FURNISH AND INSTALL 1" DRAIN LINE FROM DRAIN TROUGH OF BEVERAGE COUNTER TO FLOOR SINK - DIVISION 15.
- FURNISH AND INSTALL 1" DRAIN LINE FROM ICE BIN TO FLOOR DRAIN - DIVISION 15. 2" AIR-GAP REQUIRED.
- FURNISH AND INSTALL 1" DRAIN LINE FROM DROP-IN HOT FOOD UNIT TO FLOOR DRAIN - DIVISION 15. 2" AIR-GAP REQUIRED.
- WALK-IN PANEL PENETRATIONS FOR REFRIGERANT PIPING AND DRAIN LINES SHALL BE SEALED WITH FOAM URETHANE.
- FURNISH AND INSTALL EXHAUST/SUPPLY FANS AND DUCTWORK (INDEPENDENT OF BUILDING HVAC SYSTEM) TO MEET REQUIREMENTS INDICATED - DIVISION 15.
- FURNISH AND INSTALL AUTOMATIC WET CHEMICAL FIRE EXTINGUISHING SYSTEM FOR EXHAUST VENTILATOR OVER COOKING EQUIPMENT TO MEET UL STANDARD 300, LATEST EDITIONS OF NFPA PAMPHLET NOS. 96 AND 17A, AND ALL OTHER APPLICABLE FIRE CODES - DIVISION 11.
- TEMPERING OF SUPPLY AIR SHALL BE IN ACCORDANCE WITH MECHANICAL SPECIFICATIONS AND FAN SYSTEM DESIGN REQUIREMENTS - DIVISION 15.
- ALL HVAC CEILING REGISTERS ARE TO BE DIRECTED AWAY FROM EXHAUST HOOD IN ACCORDANCE WITH CHAPTER 31 KITCHEN VENTILATION OF ASHRAE APPLICATIONS HANDBOOK, DATED 2007.
- DUCT ABOVE FINISHED CEILING SHALL BE WATER-TIGHT AND SLOPED SO THAT CONDENSATE FORMED WITHIN DUCT WILL DRAIN BACK INTO DISHWASHER.
- FURNISH AND INSTALL ALL-WELDED 18-GAUGE STAINLESS STEEL DUCT FROM TOP OF DISHWASHER TO 6" ABOVE FINISHED CEILING AND INSTALL JUNCTION BOX ON TOP OF WALK-IN COOLER/FREEZER FOR POWER SOURCE OF

MECHANICAL ROUGH-IN SYMBOLS & ABBREVIATIONS

CW	COLD WATER
HW	HOT WATER
GPH	GALLONS PER HOUR
PSI	POUNDS PER SQUARE INCH
DR	DIRECT CONNECTED DRAIN
FD-A	FLOOR DRAIN W/FLUSH MOUNTED GRATE
FD-B	FLOOR DRAIN W/ RECESSED GRATE
FS	FLOOR SINK W/DOME STRAINER (NO TOP GRATE)
BTU/HR	BRITISH THERMAL UNIT PER HOUR
☐	EXHAUST/SUPPLY DUCT OPENING
CFM	CUBIC FEET PER MINUTE
SP	STATIC PRESSURE
AFF	ABOVE FINISHED FLOOR
DFA	DOWN FROM ABOVE
UDS	UTILITY DISTRIBUTION SYSTEM

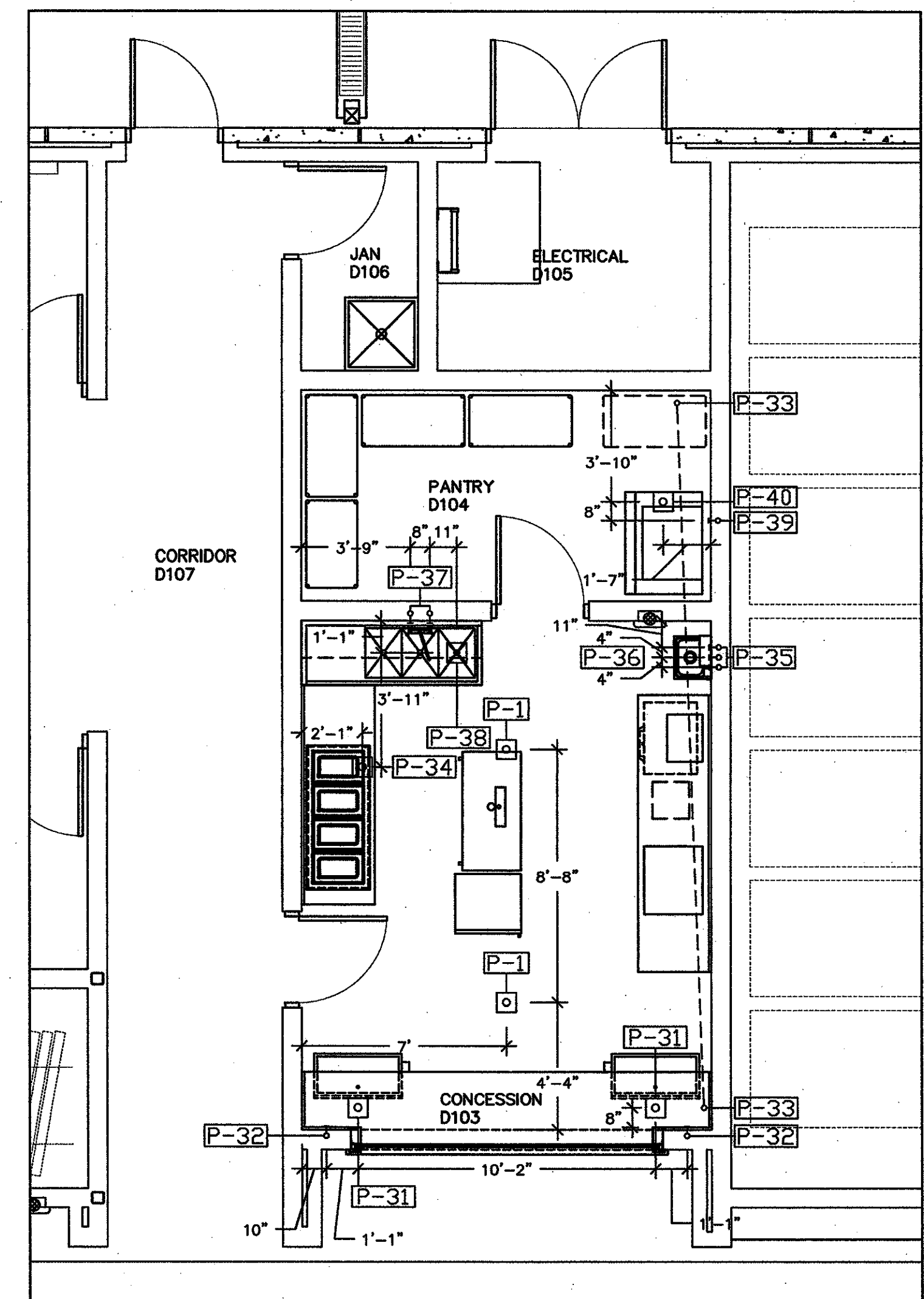
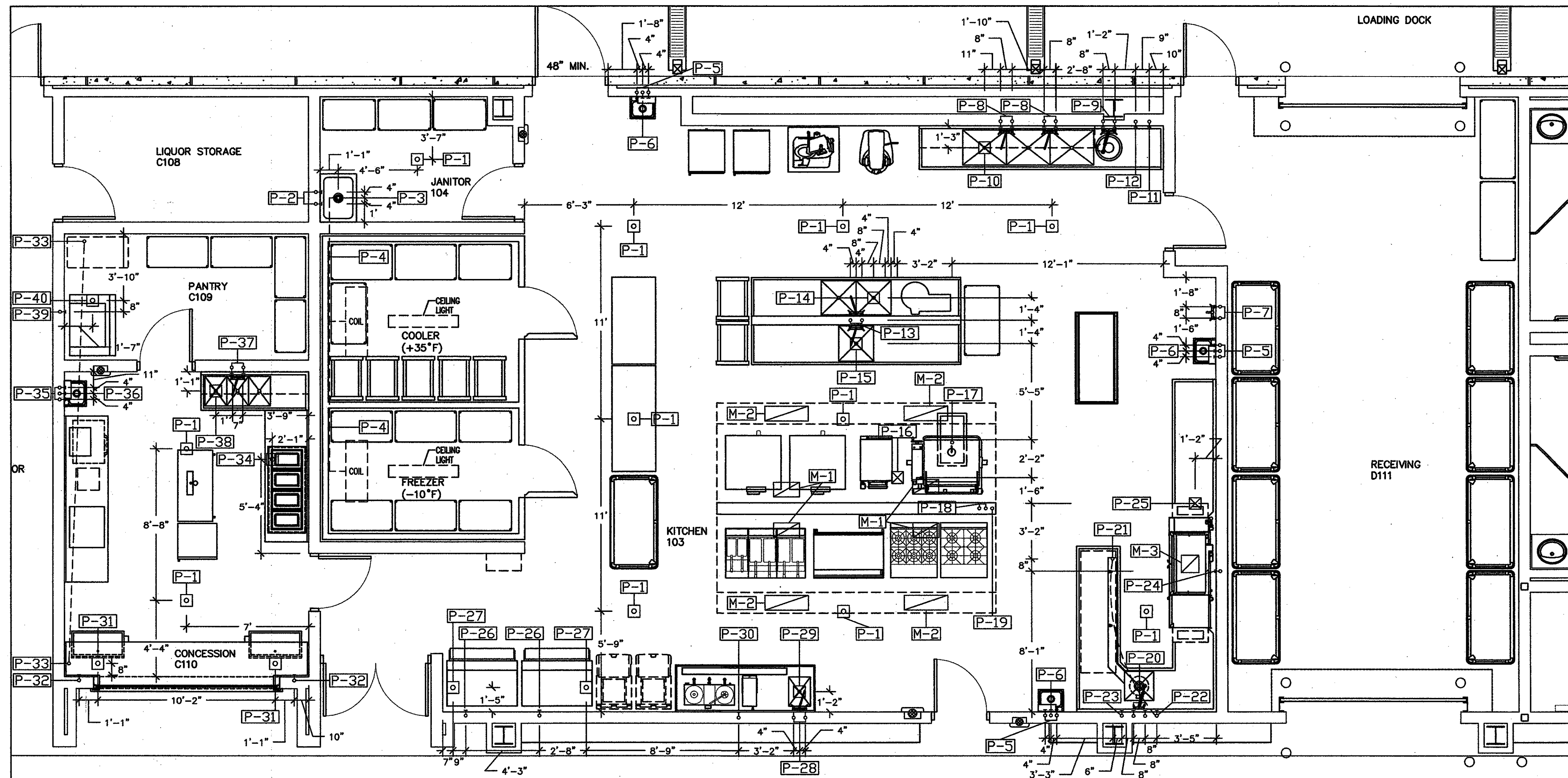

1 FOOD SERVICE EQUIPMENT MECHANICAL ROUGH-IN PLAN
FS3.0 | FS3.0 1/4" = 1'-0"

2 FOOD SERVICE EQUIPMENT MECHANICAL ROUGH-IN PLAN
FS3.0 | FS3.0 1/4" = 1'-0"

FUTCH DESIGN ASSOCIATES, INC.
FOOD FACILITIES DESIGNERS & CONSULTANTS
8966 INTERLINE AVENUE, SUITE D
BATON ROUGE, LOUISIANA 70809
225-923-1289 WWW.FUTCHDESIGN.COM
999

Project no. 20-0801
drawn JLF
checked MF
date 01.05.2010
revised

MEYER ENGINEERS, LTD.
ENGINEER & ARCHITECT

BUILDING FLOOR PLAN
VAL RIESS PARK
MULTI-PURPOSE BUILDING
ST. BERNARD PARISH, OWNER

sheet no. **FS3.0**
of ___ sheets